



YouTestMe

Linearized tables

Table of Contents

- 1 Introduction..... 2
 - 1.1 Precondition – Accessibility mode 2
- 2 Linearized tables..... 3

1 Introduction

This document's purpose is to demonstrate that all tables in the application are linearized and easy to navigate.

1.1 Precondition – Accessibility mode

To enter accessibility mode, follow these steps:

1. In the **Users** section, select **My Profile**.

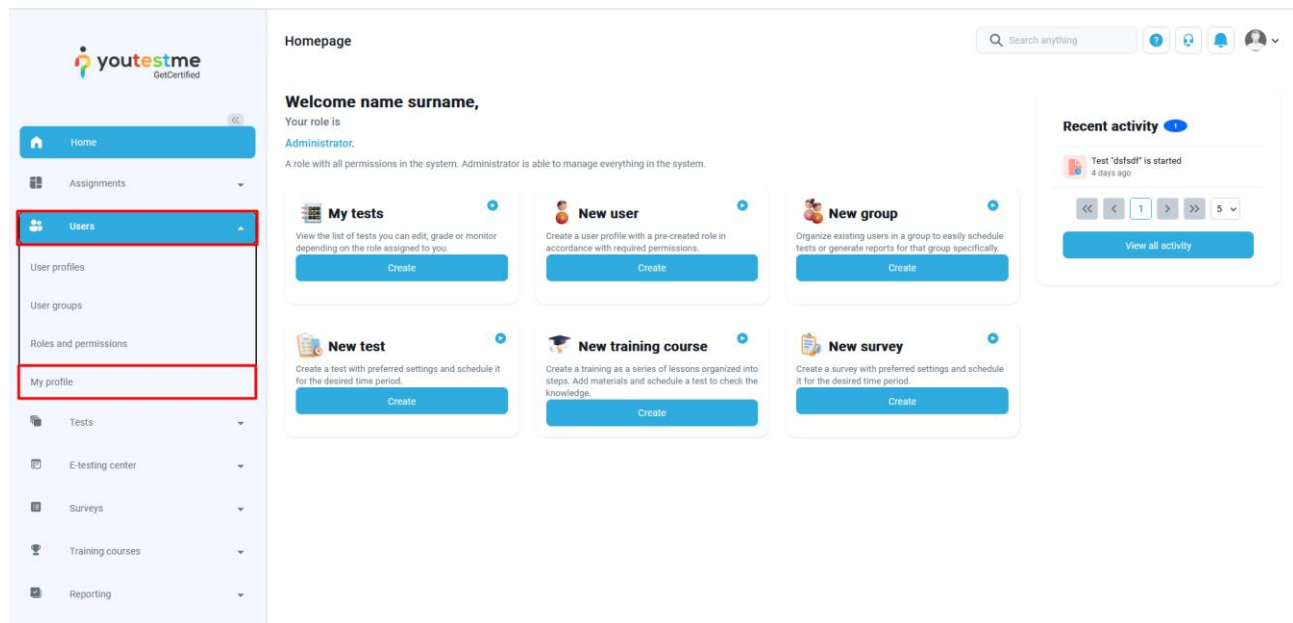

2. In the **Information** tab, select the **Accessibility** menu option and make sure the "Turn on accessibility mode" option is checked.

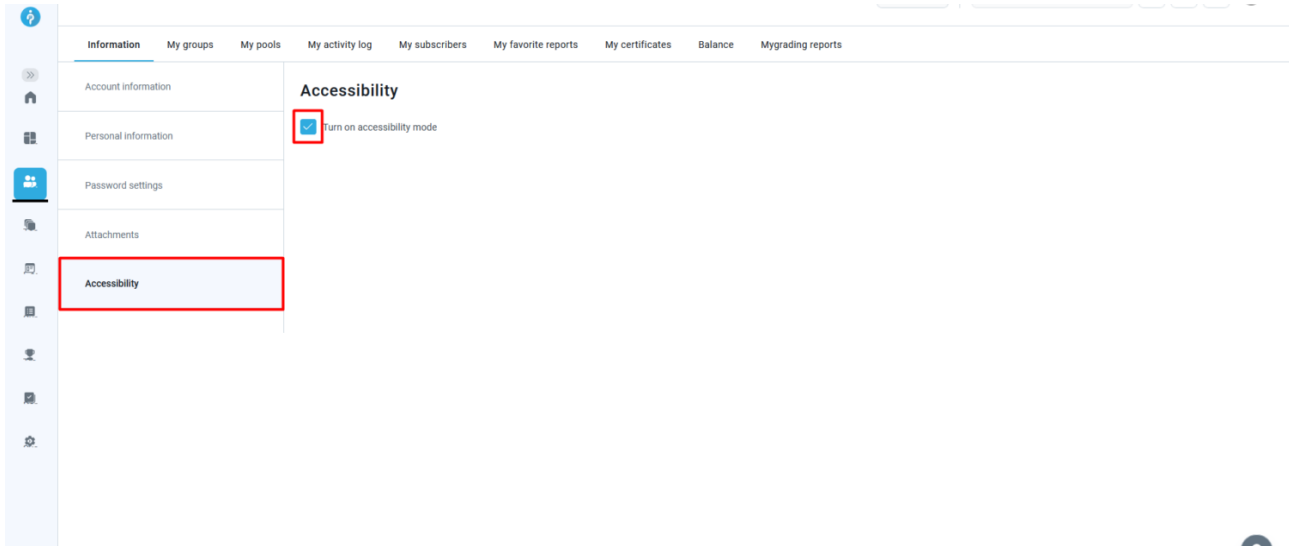

2 Linearized tables

The picture below is an example of a linearized table from the **Manage tests** option in the **Tests** section.

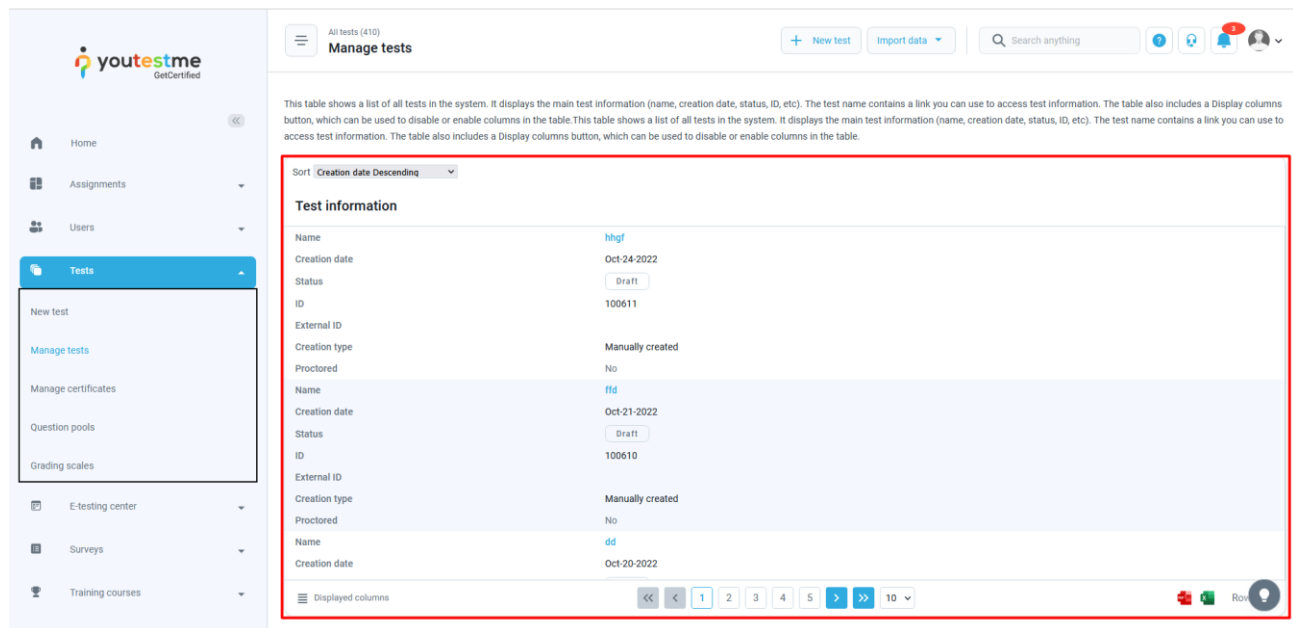

For more straightforward navigation, you can choose among multiple sorting options by using the arrow keys.

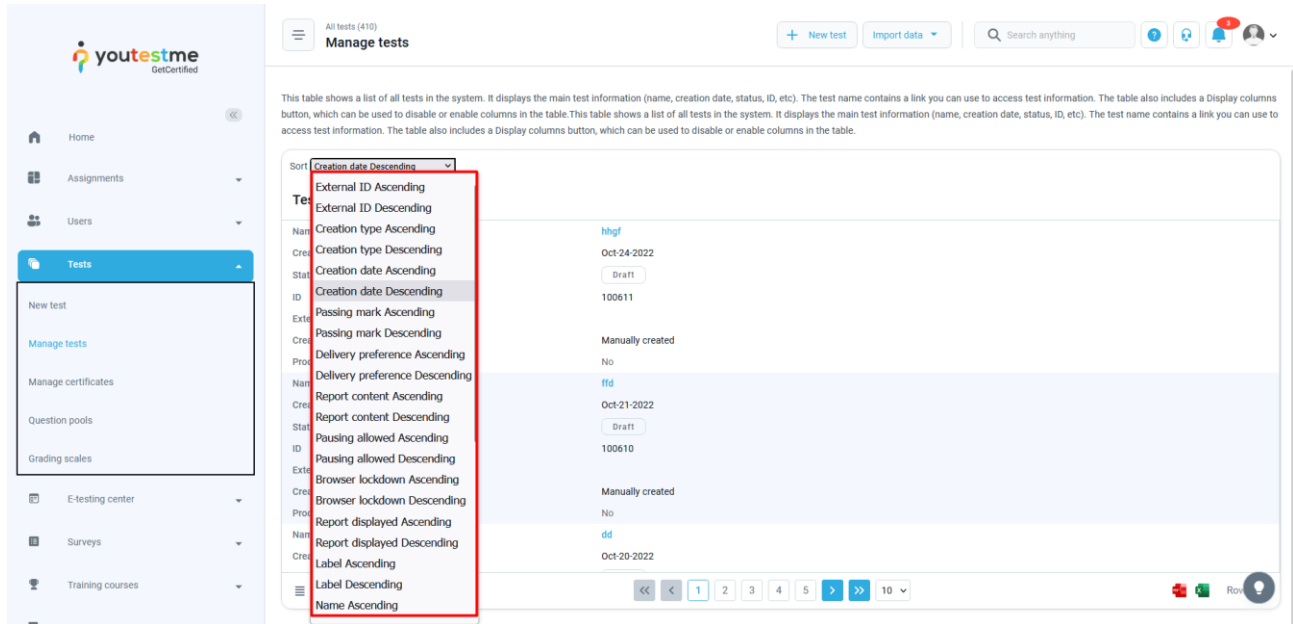

Test information is displayed in rows instead of columns, as in the pre-linearized version. To select a test, use the **Tab** and **Enter** keys.

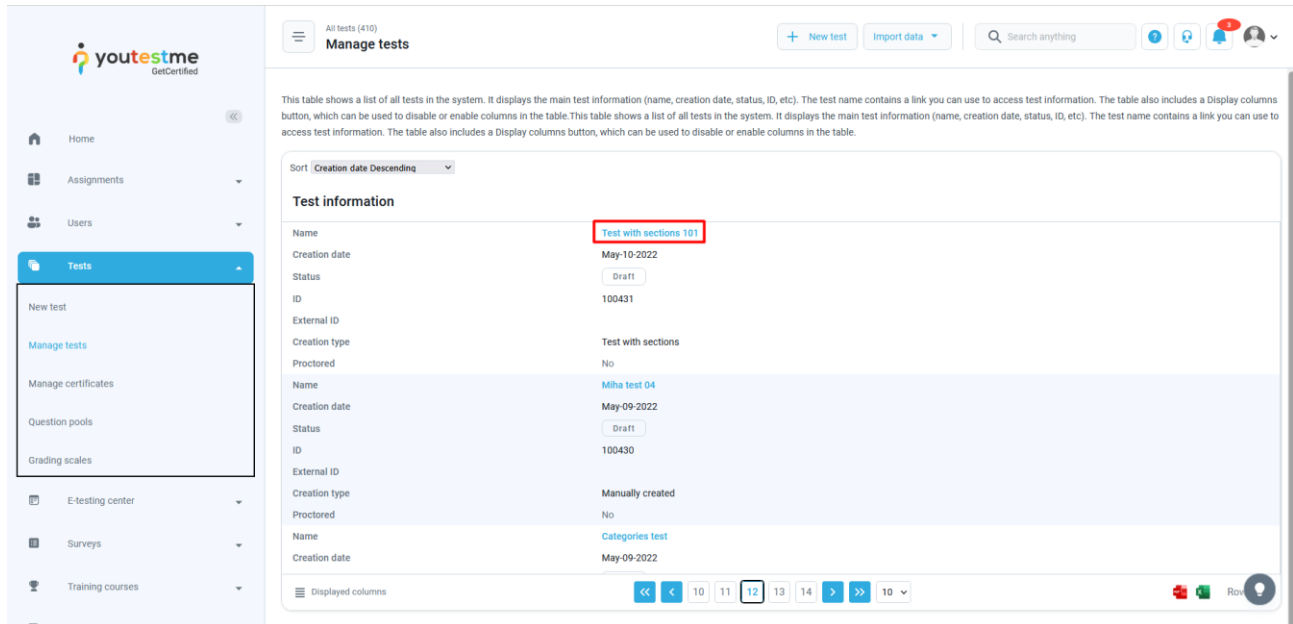

In order for the screen reader to read all the information in the table, use the **Up** and **Down** arrow keys combined with **Ctrl + Alt**.

All tests (419) **Manage tests** [+ New test](#) [Import data](#)

This table shows a list of all tests in the system. It displays the main test information (name, creation date, status, ID, etc). The test name contains a link you can use to access test information. The table also includes a Display columns button, which can be used to disable or enable columns in the table. This table shows a list of all tests in the system. It displays the main test information (name, creation date, status, ID, etc). The test name contains a link you can use to access test information. The table also includes a Display columns button, which can be used to disable or enable columns in the table.

Sort **Creation date Descending**

Test information

Name	Test with sections 101
Creation date	May-10-2022
Status	Draft
ID	100431
External ID	
Creation type	Test with sections
Proctored	No
Name	Miha test 04
Creation date	May-09-2022
Status	Draft
ID	100430
External ID	
Creation type	Manually created
Proctored	No
Name	Categories test
Creation date	May-09-2022

Displayed columns 10 11 12 13 14 10