



YouTestMe

Text-equivalent descriptions of non-text elements

Table of Contents

- 1 Introduction..... 2
 - 1.1 Precondition – Accessibility mode 2
- 2 Non-text elements without text equivalent descriptions 3
- 3 Non-text elements with text equivalent descriptions..... 5

1 Introduction

This document's purpose is to demonstrate that all non-text elements have text-equivalent descriptions. Images that do not convey content, are decorative, or with content already conveyed in the text are given null alt text or implemented as CSS backgrounds. All images, form image buttons, and image map hot spots have appropriate, concise alternative text

1.1 Precondition – Accessibility mode

To enter accessibility mode, follow these steps:

1. In the **Users** section, select **My Profile**.

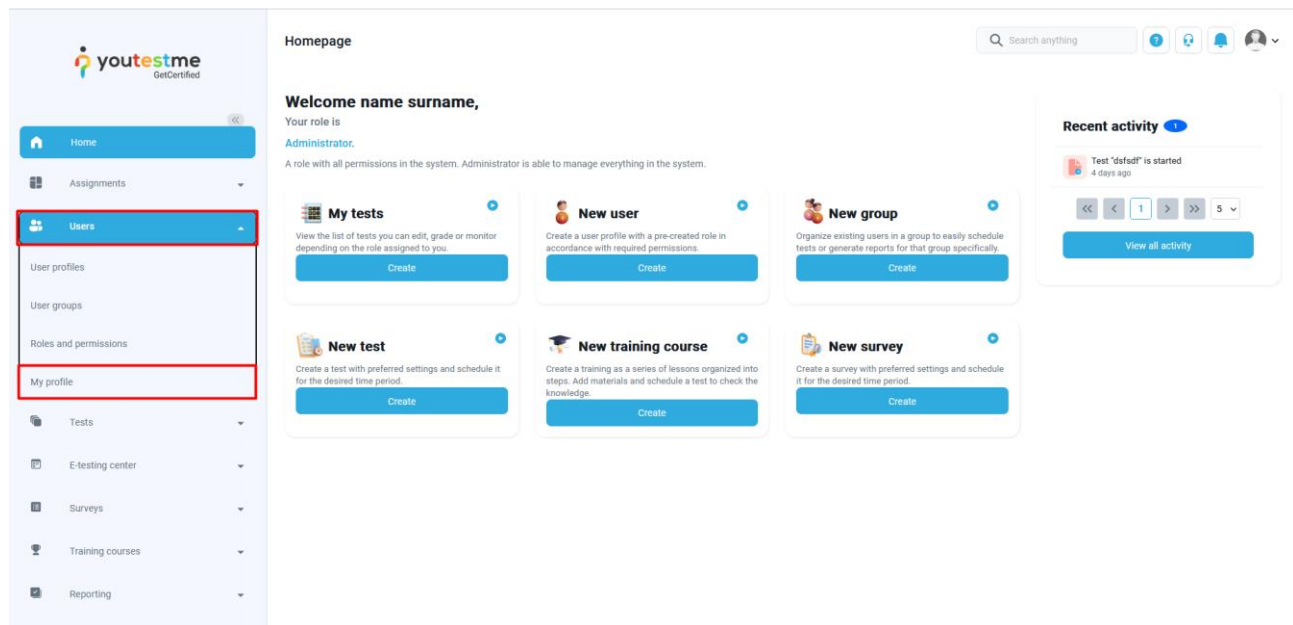

2. In the **Information** tab, select the **Accessibility** menu option and make sure the "Turn on accessibility mode" option is checked.

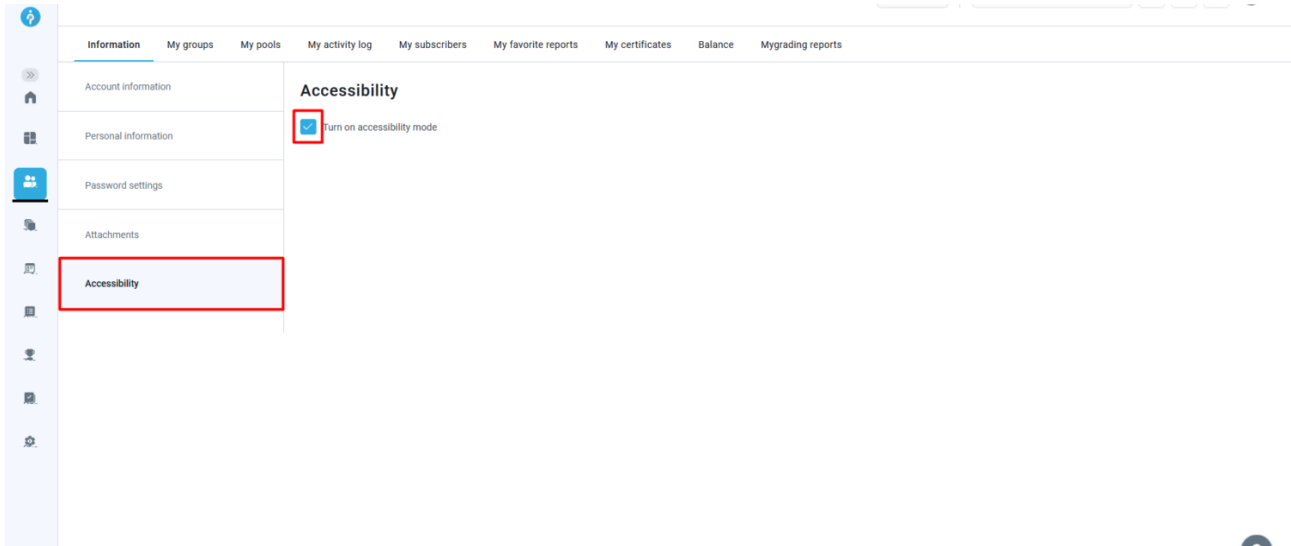

2 Non-text elements without text equivalent descriptions

Decorative images are not given text equivalent descriptions.

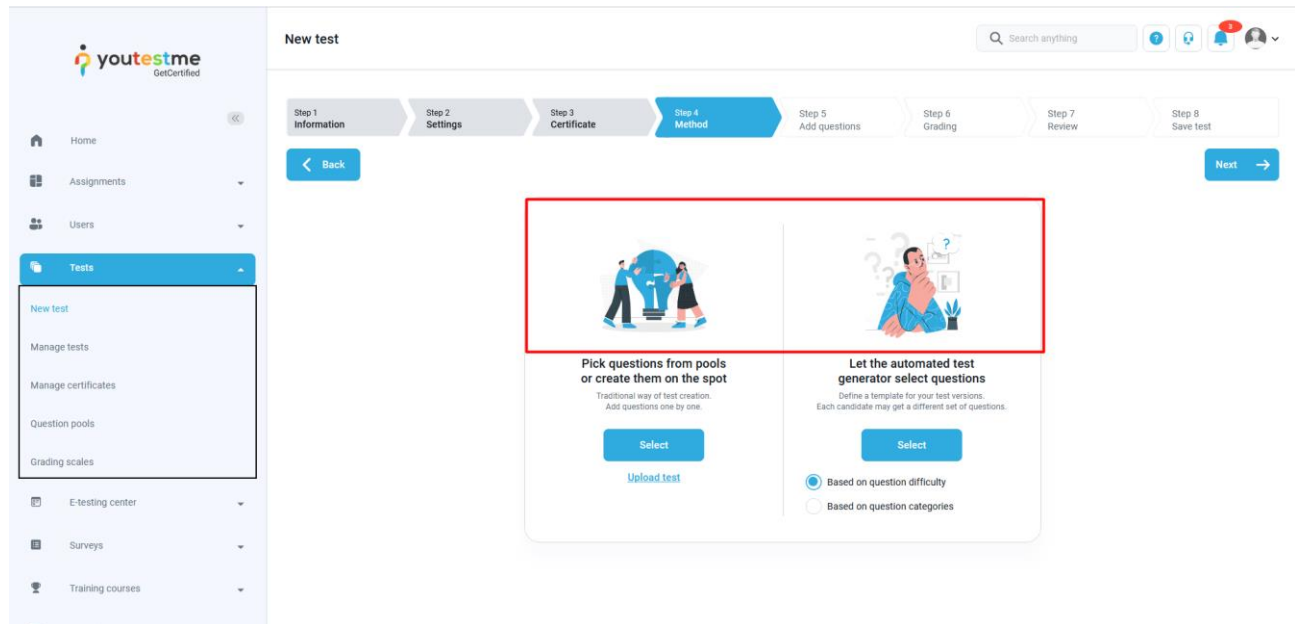

Neither are images with content already conveyed in the text.

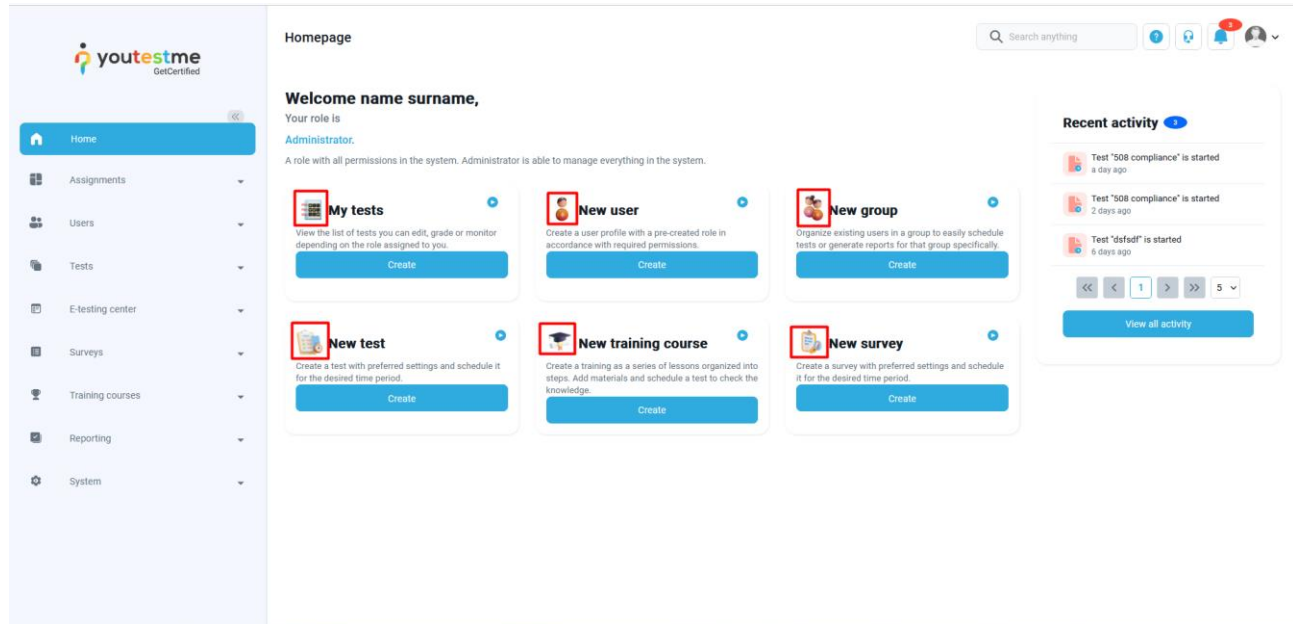



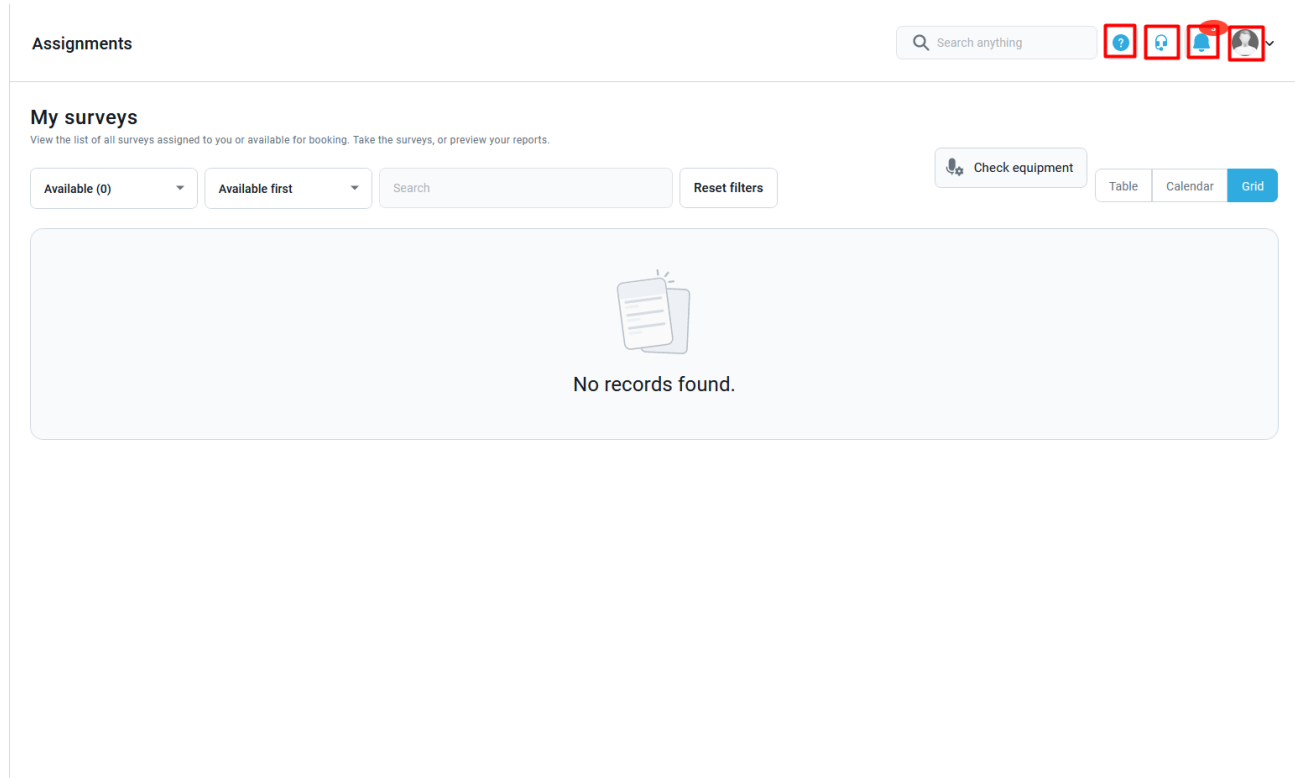

The screenshot displays the youtestme homepage for an administrator. On the left is a vertical navigation menu with items: Home, Assignments, Users, Tests, E-testing center, Surveys, Training courses, Reporting, and System. The main content area is titled 'Homepage' and includes a search bar and user profile icons. A welcome message identifies the user as an Administrator. Below this, six 'Create' buttons are arranged in a 2x3 grid, each with a red box highlighting its icon: 'My tests' (calendar icon), 'New user' (person icon), 'New group' (group of people icon), 'New test' (document icon), 'New training course' (graduation cap icon), and 'New survey' (survey form icon). Each button includes a brief description of the action. On the right, a 'Recent activity' section shows a list of test events with timestamps and a 'View all activity' button.

3 Non-text elements with text equivalent descriptions

The icons in the top menu bar are recognized as following by the screen reader: user manual, contact support, notifications, and placeholder for profile picture.







Assignments Search anything    



My surveys
View the list of all surveys assigned to you or available for booking. Take the surveys, or preview your reports.

Available (0) Available first Search Reset filters Check equipment Table Calendar Grid



No records found.

The icons for exporting documents are also non-text elements with text-equivalent descriptions.

Creation date 	Status 	ID 	External ID 	Creation type 	Proctor
Oct-21-2022	<input type="button" value="Draft"/>	100610		Manually created	No
Oct-20-2022	<input type="button" value="Draft"/>	100609		Manually created	No
Oct-20-2022	<input type="button" value="Draft"/>	100608		Manually created	No
Oct-20-2022	<input type="button" value="Draft"/>	100607		Manually created	No
Oct-20-2022	<input type="button" value="Draft"/>	100606		Manually created	No
Oct-20-2022	<input type="button" value="Draft"/>	100605		Manually created	No
Oct-20-2022	<input type="button" value="Draft"/>	100604		Manually created	No
Oct-18-2022	<input type="button" value="Draft"/>	100603		Manually created	No
Oct-17-2022	<input type="button" value="Draft"/>	100601		Manually created	No
Oct-17-2022	<input type="button" value="Draft"/>	100600		Manually created	No

<< < 1 2 3 4 5 > >> 10 ▼
  Ro

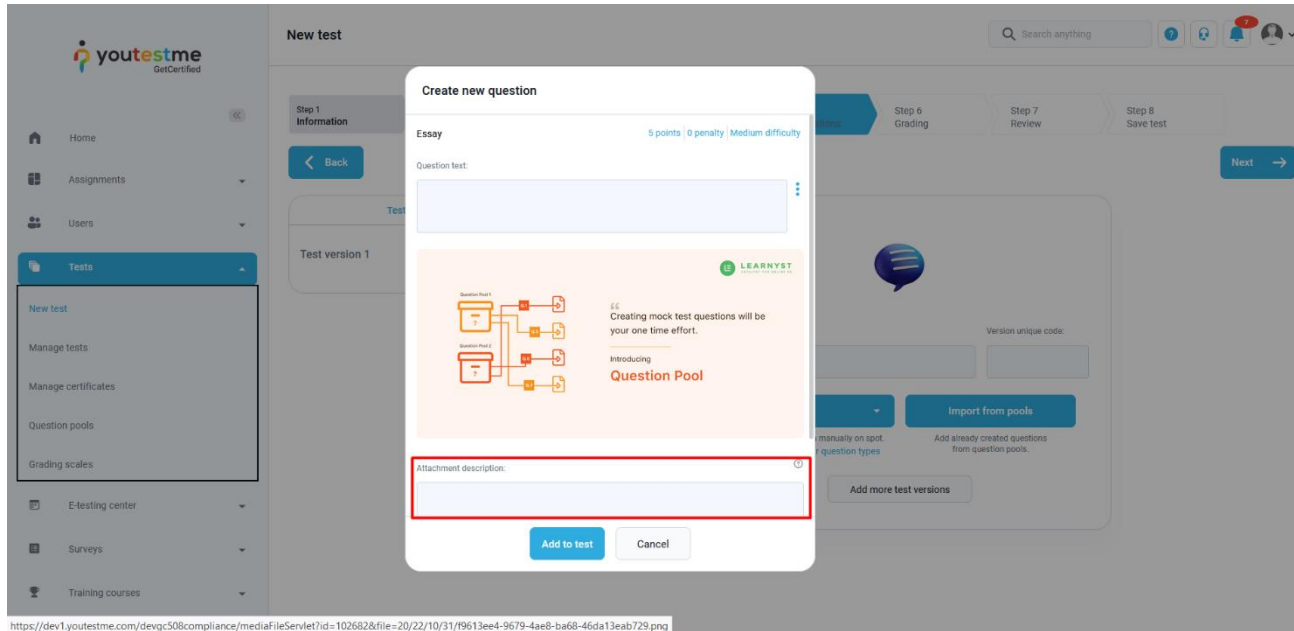
When creating questions in a test, you can add textual descriptions for non-textual elements, such as images.



When taking the test, the screen reader will read the description you added when the image is selected.

