



YouTestMe

The ability to import/export of data from your application

File name	The ability to import/export of data from your application
Author	YouTestMe
Confidentiality	Internal or Public
Last save date	Friday, October-28-2022 at 3:28:00 PM

Table of Contents

1	Introduction.....	2
2	Exporting the pass/fail entry for LMS	3

1 Introduction

This document's purpose is to explain how functions the ability to import/export of data from your application.

2 Exporting the pass/fail entry for LMS

To export the pass/fail entry for LMS, do the following:

1. Navigate to the **Tests** tab in the left side main menu.
2. Select the **Manage tests** tab.
3. Select the desired test.

Name	Creation date	Status	ID	External ID	Creation type	Proctored
Banking - Certification Exam	Sep-07-2022	Suspended	1872		Generated	No
Quick Quiz - Cryptocurrency	Sep-07-2022	Published	1871		Generated	No
Quick Quiz - Banking - 20th Centu...	Sep-07-2022	Published	1870		Generated	No
Quick Quiz - Introduction to Banki...	Sep-07-2022	Published	1869		Generated	No
Informatics and Computing	Aug-17-2022	Published	1868		Manually created	No
Is your business ready for Blockc...	Aug-17-2022	Published	1867		Manually created	No
Java Certification Practice Test	Aug-17-2022	Published	1866		Manually created	No
Principles of Taxation	Aug-17-2022	Published	1865		Manually created	No
SQL Skill and Knowledge Assess...	Aug-17-2022	Published	1864		Manually created	Yes
Project Management Certification	Aug-17-2022	Published	1863		Manually created	No

4. Open the candidates tab.
5. Click on the **Export compilation status as Excel** icon.

Username	Session	Status	Result	Score (%)	Test finished	Grade resolved	Visible to candidate
aaron	Session - New York	Report complete	Passed	20.75	Yes	Yes	Yes
Abled1959	Session - Toronto	Not attempted	-	-	-	-	-
Abled1997	Session - Toronto	Report complete	Passed	5.66	Yes	Yes	Yes
Accon1956	Session - Montreal	Not attempted	-	-	-	-	-
Acessier	Session - New York	Report complete	Passed	96.23	Yes	Yes	Yes
Acesturod	Session - Toronto	Not attempted	-	-	-	-	-
Acrew1969	Session - Montreal	Not attempted	-	-	-	-	-
Adam	Session - Toronto	Report complete	Passed	0.00	Yes	Yes	Yes
adam	Session - New York	Not attempted	-	-	-	-	-
admin	Session - Toronto	Not attempted	-	-	-	-	-

When downloading the Excel file, we can see that the file is empty. To have the data in it, the manager first has to verify reports.

1	A	B	C	D	E	F	G	H	I	J	K
2	Session start	Started	Report verification date	Grade resolved	Report verified	Test finished	Username	Email	From group	Points	Result
3											
4											
5											
6											
7											
8											
9											
10											
11											
12											
13											
14											
15											
16											
17											
18											
19											
20											
21											
22											
23											

To verify reports:

1. Select a couple of students.
2. Click on the **Action** option.
3. Select the option **Verify selected attempts**.

The screenshot shows the 'Manage tests' interface in the youtestme application. The 'Candidates' tab is active, displaying a table of candidates. An action menu is open over the table, with 'Verify selected attempts' highlighted. The table columns include Username, Session, Status, Grade resolved, and Visible to candidate. The interface also shows a sidebar with navigation options like Home, Assignments, Users, Tests, and Training courses.

Click on the **Ok** button to confirm.

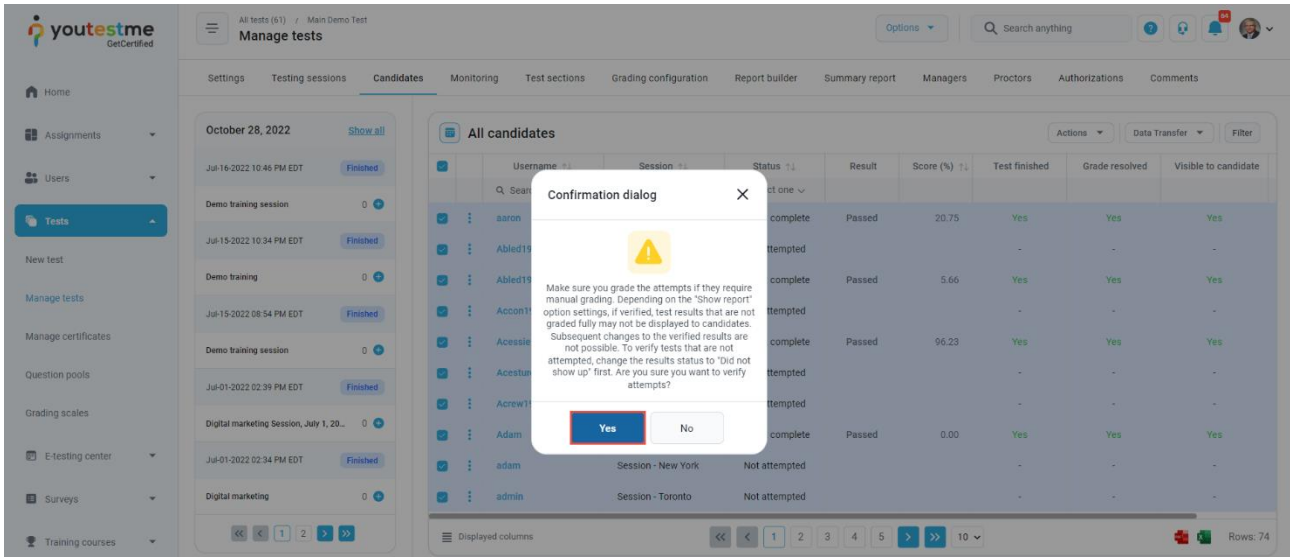

If we now export again the compilation status as Excel file, we can see the results of students who's results should be inserted in the LMS.

	A	B	C	D	E	F	G	H	I
1									
2	Session start	Started	Report verification date	Grade resolved	Report verified	Test finished	Username	Email	From g
3	Apr-01-2021 12:00 AM EDT	Jun-25-2021 12:35 PM EDT	Not verified	Yes	No	Yes	aaron	noreply@youtestme.com	-
4	Jun-01-2016 12:00 AM EDT	-	Not verified	-	-	-	Abled1959	noreply@youtestme.com	-
5	Jun-01-2016 12:00 AM EDT	Jun-25-2021 12:47 PM EDT	Not verified	Yes	No	Yes	Abled1997	noreply@youtestme.com	-
6	Jun-01-2022 12:00 AM EDT	-	Not verified	-	-	-	Accon1956	noreply@youtestme.com	-
7	Apr-01-2021 12:00 AM EDT	Jun-25-2021 12:34 PM EDT	Not verified	Yes	No	Yes	Accessier	noreply@youtestme.com	-
8	Jun-01-2016 12:00 AM EDT	-	Not verified	-	-	-	Acesturod	noreply@youtestme.com	-
9	Jun-01-2022 12:00 AM EDT	-	Not verified	-	-	-	Acrew1969	noreply@youtestme.com	-
10	Apr-01-2021 12:00 AM EDT	-	Not verified	-	-	-	adam	noreply@youtestme.com	-
11	Jun-01-2016 12:00 AM EDT	May-31-2022 07:07 PM EDT	Not verified	Yes	No	Yes	Adam	noreply@youtestme.com	-
12	Jun-01-2016 12:00 AM EDT	-	Not verified	-	-	-	admin	noreply@youtestme.com	-
13	Jun-01-2016 12:00 AM EDT	-	Not verified	-	-	-	Afrand	noreply@youtestme.com	-
14	Apr-01-2021 12:00 AM EDT	-	Not verified	-	-	-	Aftervince	noreply@youtestme.com	-
15	Jun-01-2022 12:00 AM EDT	-	Not verified	-	-	-	Agar1967	noreply@youtestme.com	-
16	Apr-01-2021 12:00 AM EDT	-	Not verified	-	-	-	Agpitaidethe	noreply@youtestme.com	-
17	Jun-01-2016 12:00 AM EDT	-	Not verified	-	-	-	albert	noreply@youtestme.com	-
18	Jun-01-2022 12:00 AM EDT	-	Not verified	-	-	-	Albert_Mccoy	noreply@youtestme.com	-
19	Apr-01-2021 12:00 AM EDT	-	Not verified	-	-	-	alexander	noreply@youtestme.com	-