



YouTestMe

Question groups

File name	Question groups
Author	YouTestMe
Confidentiality	Internal or Public
Last save date	Tuesday, October-25-2022 at 3:26:00 PM

Table of Contents

1 Introduction..... 2

2 Adding images 2

1 Introduction

This document explains how to:

- Permit text or images to be used during exams.
- Allow split and adjustable screens for text or images to be presented next to, above, or below test questions.

2 Adding images

To access the question pool, you should navigate to **Tests** and select **Question pools**.

The screenshot shows the YouTestMe homepage for an Administrator. The left sidebar contains a menu with 'Tests' highlighted. The main content area includes a welcome message, a list of quick actions (My tests, New user, New user group, New test, New training course, New survey), and a 'Recent activity' section. The 'Question pools' option is highlighted in red in the sidebar.

Click on the pool's name you want to enter the question in.

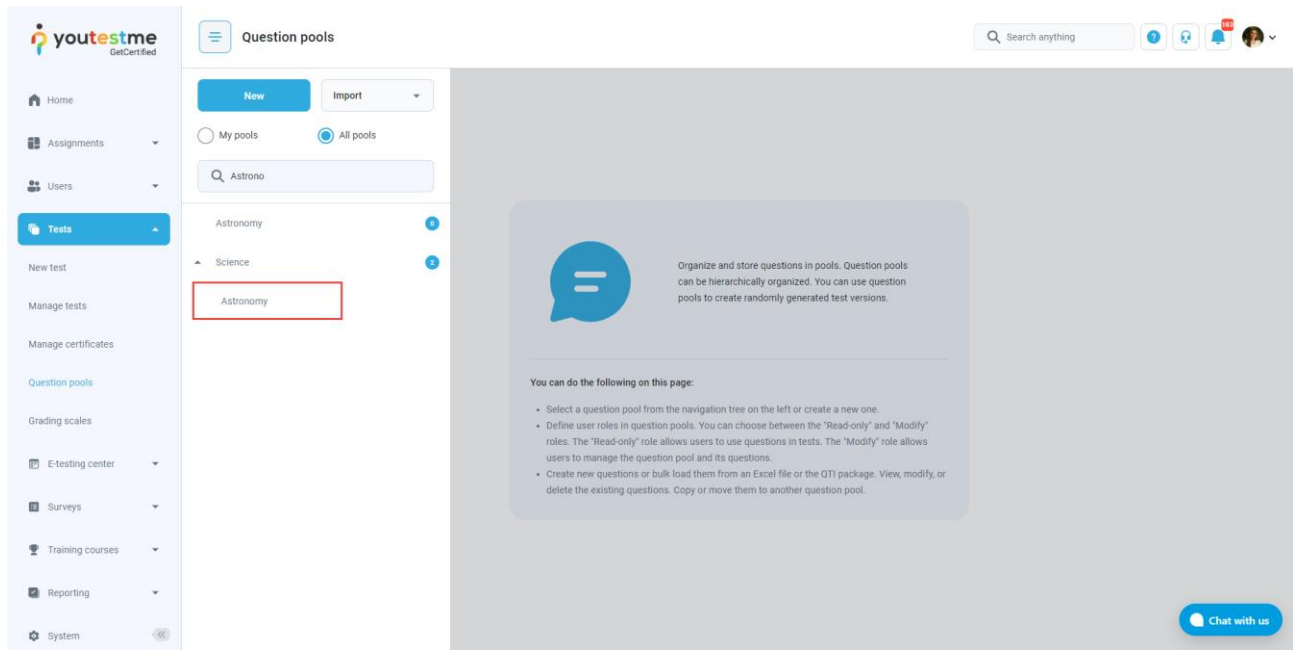

In the **Questions** tab, click on the drop-down menu and select which type of question you want to create. The example below shows the **True/False** type of question.

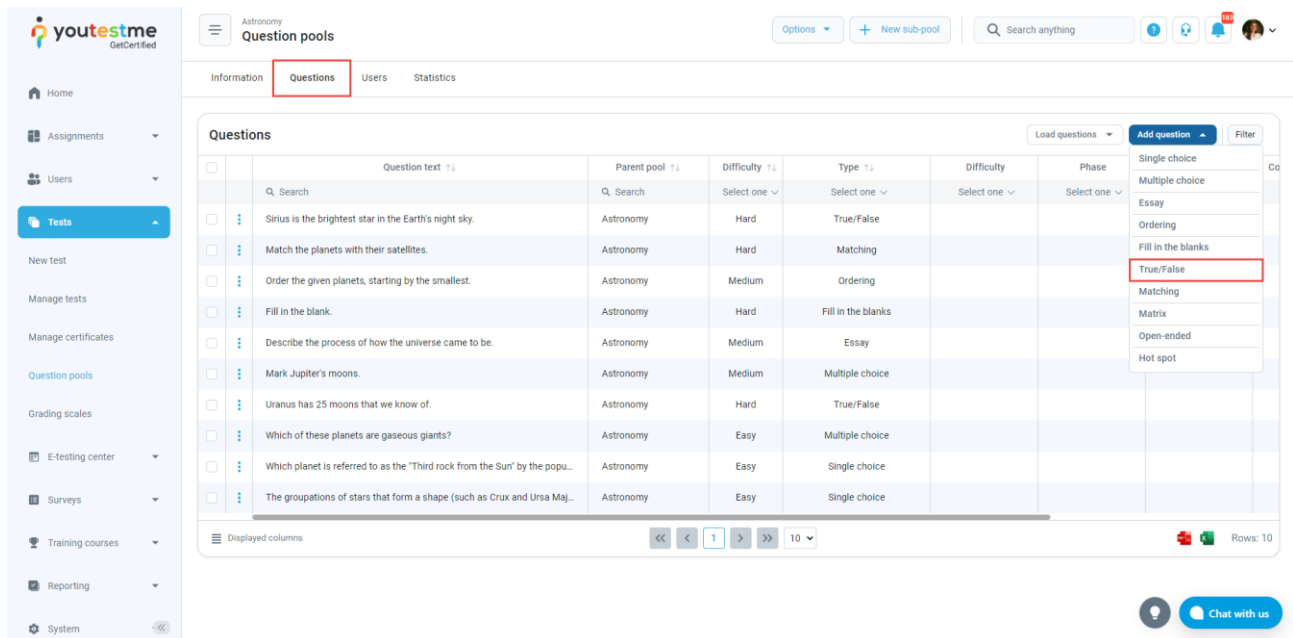

A question creation form will appear. To attach a multimedia question, click on the **Action** option and choose the **Upload attachment** option to import the desired image from your PC. The image will appear in the text editor.

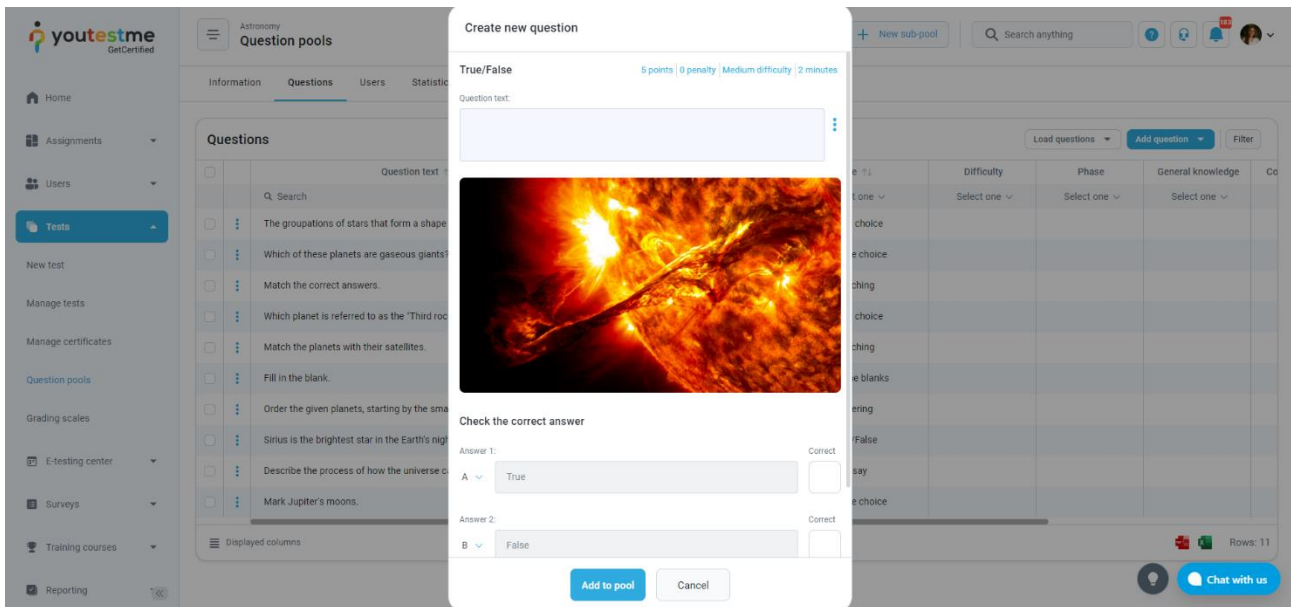
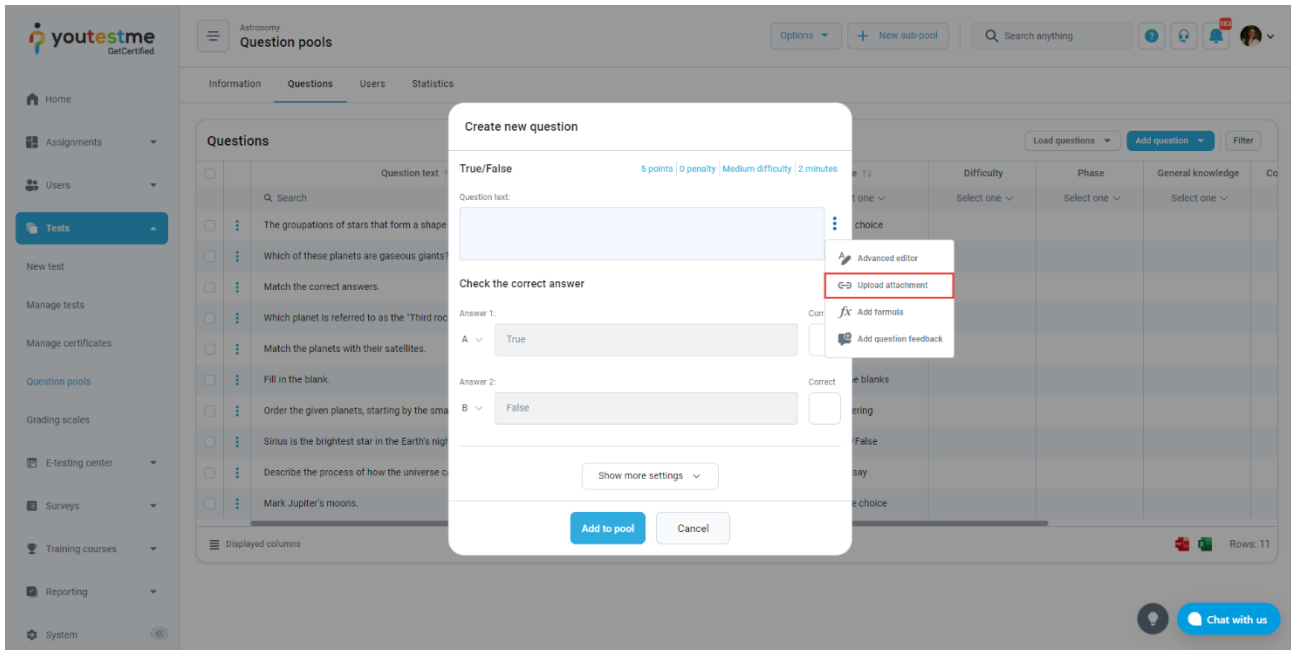

Note: Students will be able to click on the image, large it, and provide the answer to the question during the exam.