



YouTestMe

Answer feedback

File name	Answer feedback
Author	YouTestMe
Confidentiality	Internal or Public
Last save date	Thursday, October-20-2022 at 1:19:00 PM

Table of Contents

- 1 Introduction..... 2
- 2 Creating a test..... 2
- 3 Displaying feedbacks from the candidate’s perspective..... 7

1 Introduction

This document explains how to provide feedback to selected answers. Answer feedback can be defined for each answer and displayed when the candidate selects the corresponding answer in the test.

2 Creating a test

Hover over the **Tests** in the main menu and select **New test**.

The screenshot shows the YouTestMe Admin Dashboard. On the left is a navigation menu with 'Tests' highlighted. The main content area shows a 'Welcome John Smith' message and a list of actions to take as an administrator. At the bottom, there are several 'Create' buttons for 'My tests', 'New user', 'New user group', 'New test', 'New training course', and 'New survey'. On the right side, there is a 'Recent activity' widget showing a list of recent events like 'Test Multimedia Demo Test is started' and 'Question pool BOJANA is created'.

Enter the basic test information in the first step of the test creation process, then click the **Next** button.

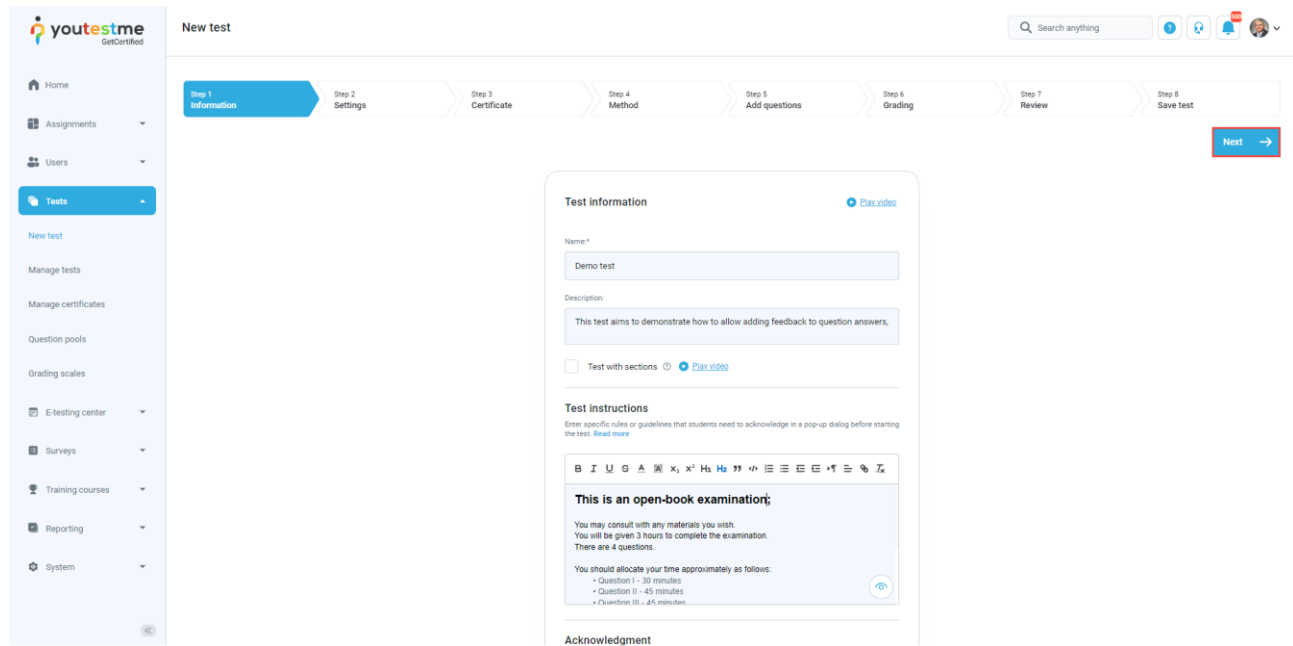

Tick the box **Enable answer feedback**. Optionally, configure other test settings.

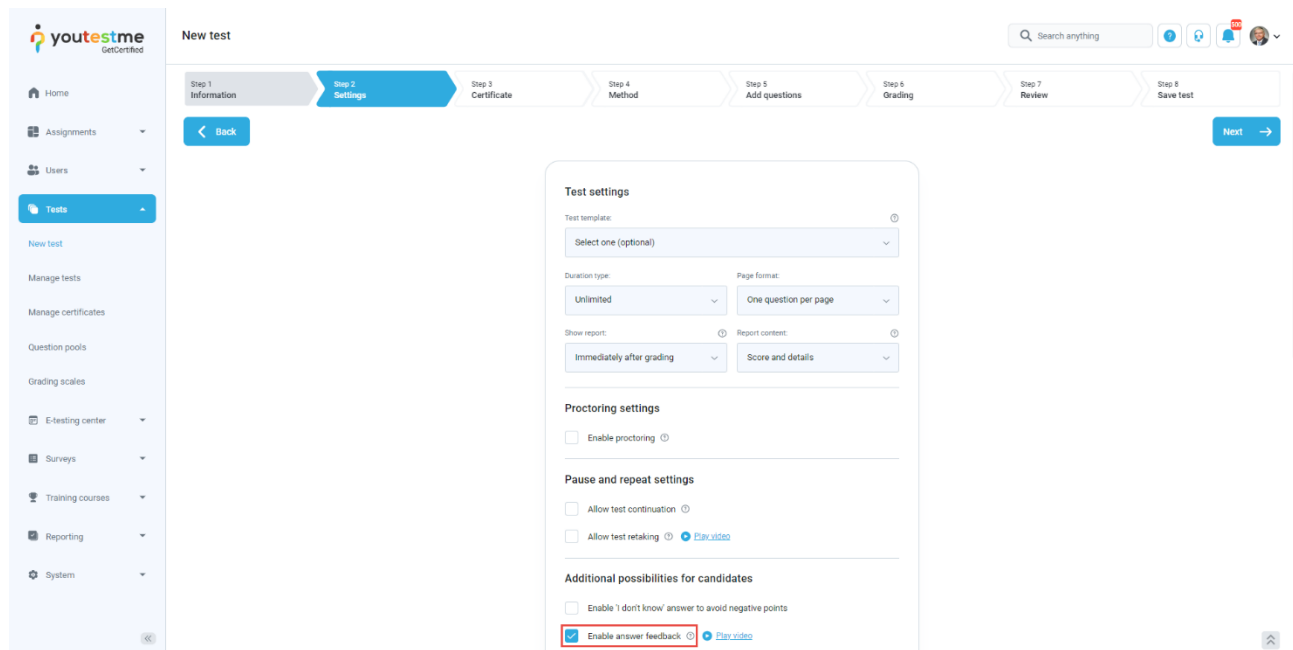

In the fifth step of the test creation wizard, choose how to add questions to your test. After you import or create new questions, you can add feedback to the desired questions and answers. Click on the **Action** option to open the question editor.

For example, click on the Action option and select the **Add feedback for this answer** to add feedback on the multiple-choice question type. Please see the **Question pools** topic for more information on how to create each question type.

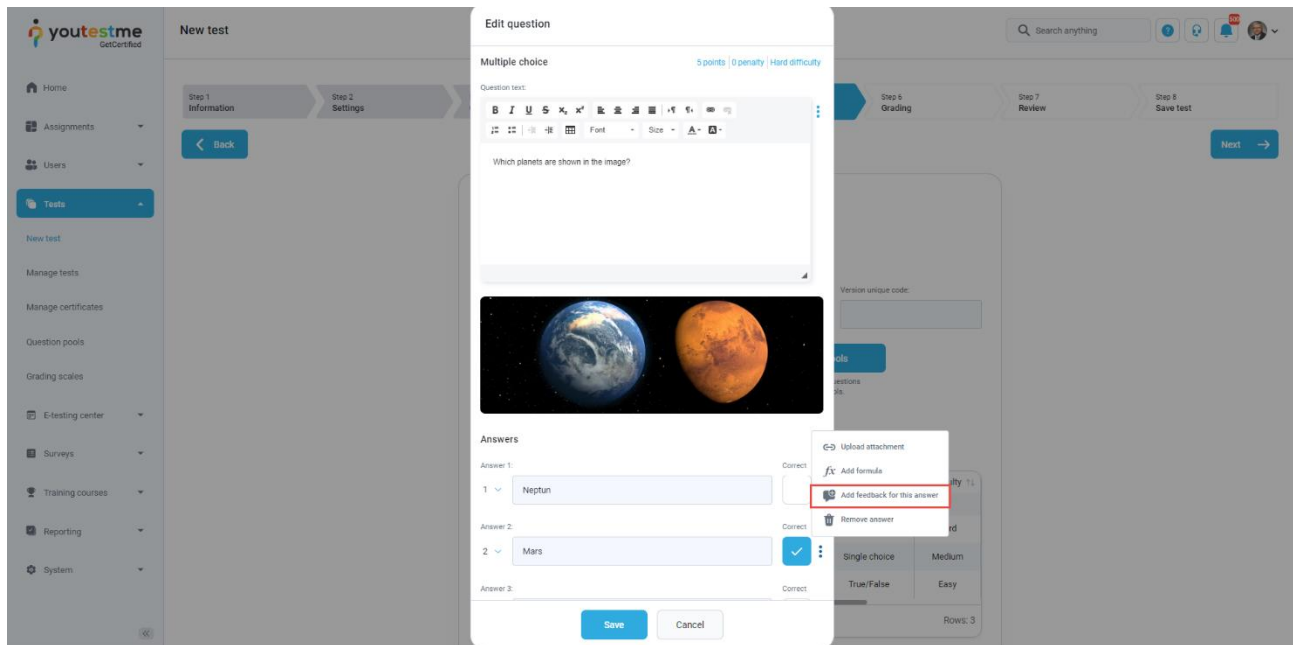

Note: You can define answer feedback also in the **Question pools** section in the **Tests** module. However, the option must be enabled in the test settings for feedback to be displayed.

1. Enter the feedback text. This text will be displayed to candidates during the test-taking process only if they choose this answer.
2. Click the **Save** button to add feedback for this answer.

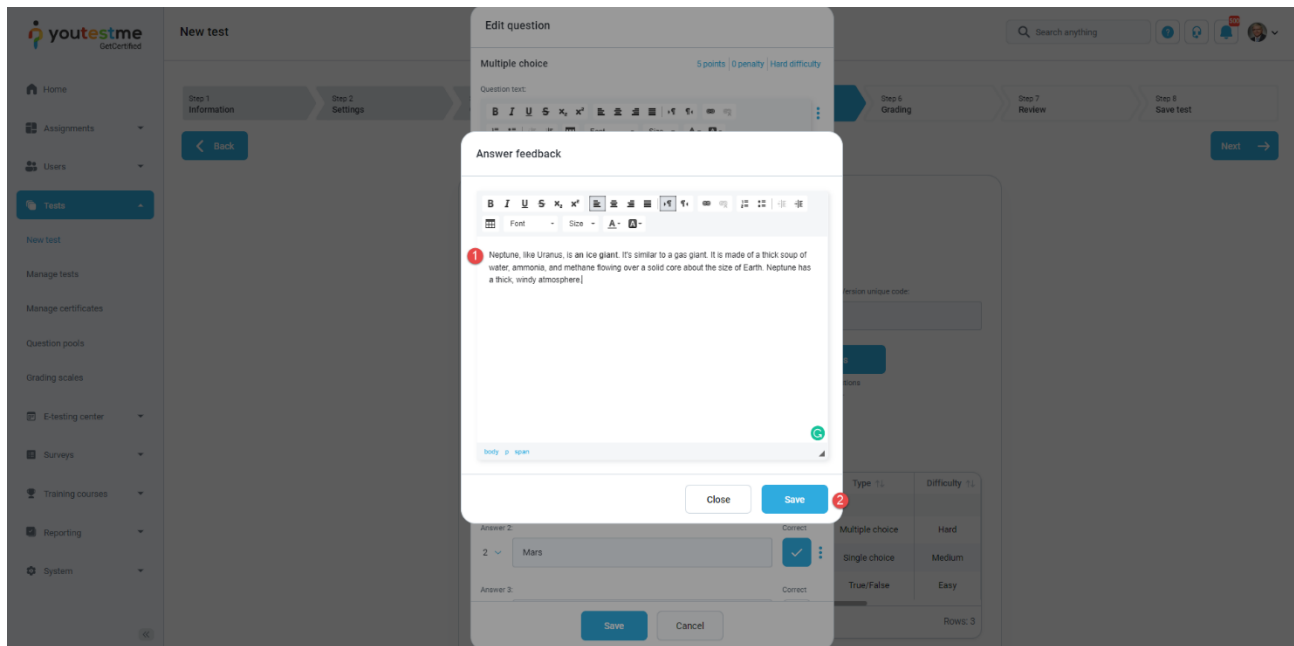

Note: You can define feedback for each or selected answers to a particular question.

Finish creating the question by clicking the **Add to test** button. You can edit or delete feedback by clicking the **Delete answer feedback**.

Edit question

Multiple choice 5 points 0 penalty Hard difficulty

Question text:

Which planets are shown in the image?

Answers

Answer 1: Correct This answer has feedback

Answer 2: Correct Delete feedback

Answer 3: Correct

Save **Cancel**

- Upload attachment
- Add formula
- Delete feedback**
- Remove answer

You can add as many questions as you want, choose additional test settings, complete the Test Wizard and publish the test.

Note: It is possible to add answer feedback for single-choice, multiple-choice, and true/false questions.

3 Displaying feedbacks from the candidate's perspective

In questions that contain answer feedback, when the candidate selects the desired answer(s) and clicks the **Next** or **Finish test** buttons, the feedback will appear.

An example is shown in the picture below.

