



# YouTestMe

Answer feedback  
for  
Each choice option

<b>File name</b>	How to add specific feedback to each choice option
<b>Author</b>	YouTestMe
<b>Confidentiality</b>	Internal or Public
<b>Last save date</b>	Tuesday, October-25-2022 at 3:27:00 PM

## Table of Contents

1	Introduction.....	2
2	Steps.....	2
2.1	Creating a test.....	2
3	Displaying feedbacks from the candidate’s perspective.....	8

## 1 Introduction

This document explains how to add specific feedback to each choice option and ability to withhold feedback on tests must also be an option.

## 2 Steps

To enable the answer feedback option, you need to create a test and configure its settings regarding answer feedback.

### 2.1 Creating a test

Hover over the **Tests** in the main menu and select **New test**.

Homepage

Welcome John Smith,  
Your role is Administrator.  
Your security role is intended for:  
- Overseeing the entire system  
- Configuring system settings  
- Examining reports

As a start, we advise you to:  
1. Click the Tests option from the main menu  
2. Select the Manage tests option  
3. Under the Name column, search for Report Builder Test and select it  
4. Select the Summary report to see the overall statistics  
5. Select the Report builder to generate your report.

**My tests**  
View the list of tests you can edit, grade or monitor depending on the role assigned to you.  
[View](#)

**New user**  
Create a user profile with a pre-created role in accordance with required permissions.  
[Create](#)

**New user group**  
Organize existing users in a group to easily schedule tests or generate reports for that group specifically.  
[Create](#)

**New test**  
Create a test with preferred settings and schedule it for the desired time period.  
[Create](#)

**New training course**  
Create a training as a series of lessons organized into steps. Add materials and schedule a test to check the knowledge.  
[Create](#)

**New survey**  
Create a survey with preferred settings and schedule it for the desired time period.  
[Create](#)

**Recent activity**

- Test "Multimedia Demo Test" is started 14 minutes ago
- Test "Multimedia Demo Test" is started 14 minutes ago
- Training course "mqj training" is created about 24 hours ago
- Question pool "BOJANAAA" is created a day ago
- Question pool "BOJANA" is created a day ago

[View all activity](#)

Enter the basic test information in the first step of the test creation process, then click the **Next** button.

New test

Step 1 Information Step 2 Settings Step 3 Certificate Step 4 Method Step 5 Add questions Step 6 Grading Step 7 Review Step 8 Save test

[Next](#)

**Test information** [Play video](#)

Name\*  
Demo test

Description:  
This test aims to demonstrate how to allow adding feedback to question answers.

Test with sections [Play video](#)

**Test instructions**  
Enter specific rules or guidelines that students need to acknowledge in a pop-up dialog before starting the test. [Read more](#)

B I U G A  $\times^2$  H<sub>2</sub>  $\frac{1}{2}$   $\frac{1}{3}$   $\frac{1}{4}$   $\frac{1}{5}$   $\frac{1}{6}$   $\frac{1}{7}$   $\frac{1}{8}$   $\frac{1}{9}$   $\frac{1}{10}$   $\frac{1}{11}$   $\frac{1}{12}$

**This is an open-book examination;**

You may consult with any materials you wish.  
You will be given 3 hours to complete the examination.  
There are 4 questions.

You should allocate your time approximately as follows:

- Question I - 30 minutes
- Question II - 45 minutes
- Question III - 45 minutes

Acknowledgment

Tick the box **Enable answer feedback**. Optionally, configure other test settings.

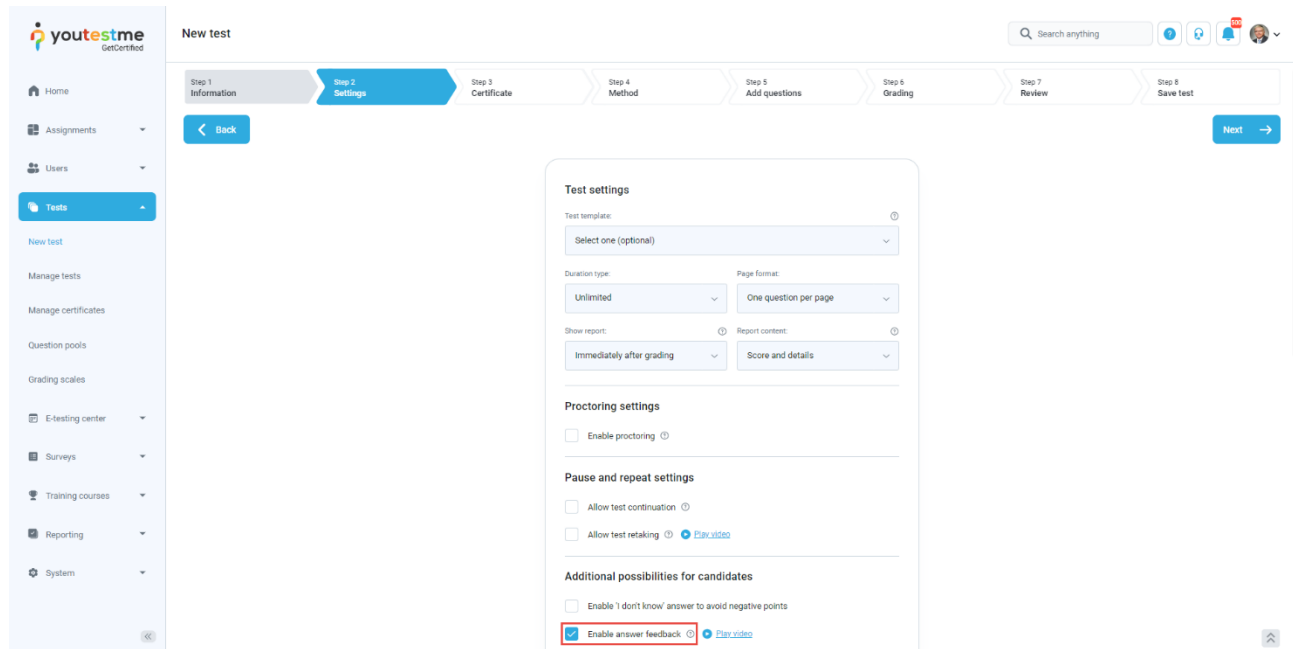

In the fifth step of the test creation wizard, choose how to add questions to your test. After you import or create new questions, you can add feedback to the desired questions and answers. Click on the **Action** option to open the question editor.

For example, click the **Add feedback for this answer** to add feedback on the multiple-choice question type. Feedback can be specific to each choice option. Please see the **Question pools** topic for more information on how to create each question type.

**Note:** You can define answer feedback also in the **Question Pools** section in the **Tests** module. However, the option must be enabled in the test settings for feedback to be displayed.

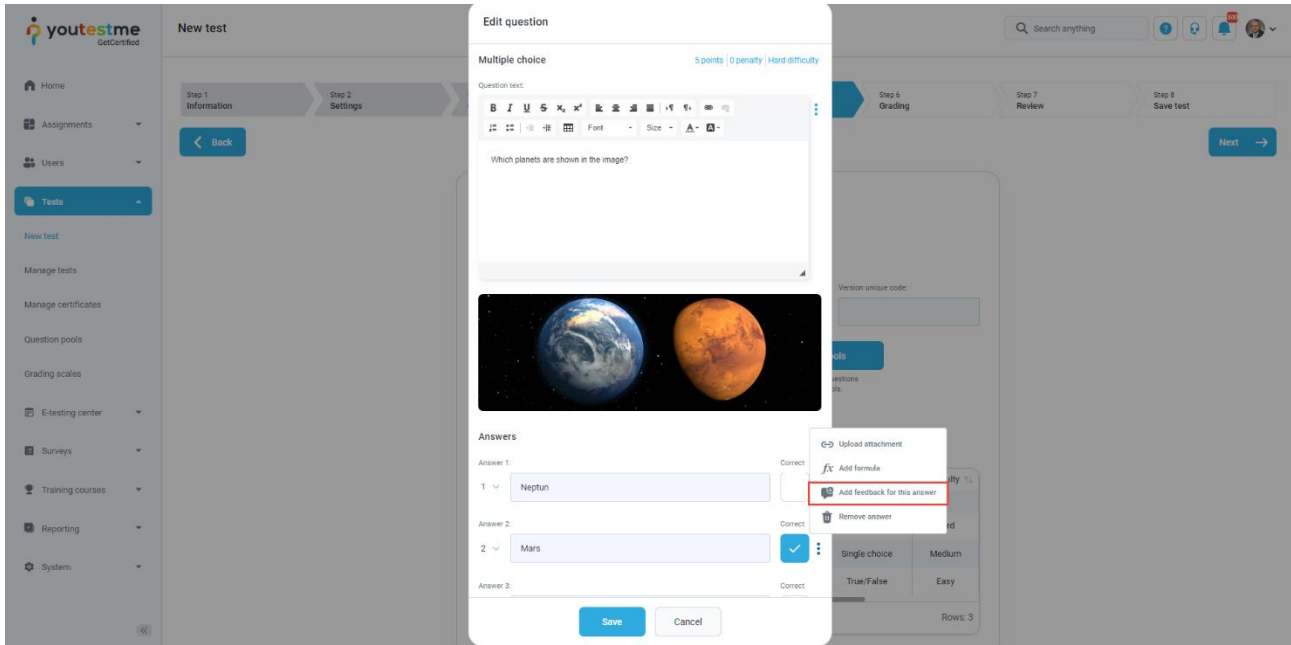

**Note:** You can define answer feedback also in the **Question pools** section in the **Tests** module. However, the option must be enabled in the test settings for feedback to be displayed.

1. Enter the feedback text. This text will be displayed to candidates during the test-taking process only if they choose this answer.
2. Click the **Save** button to add feedback for this answer.

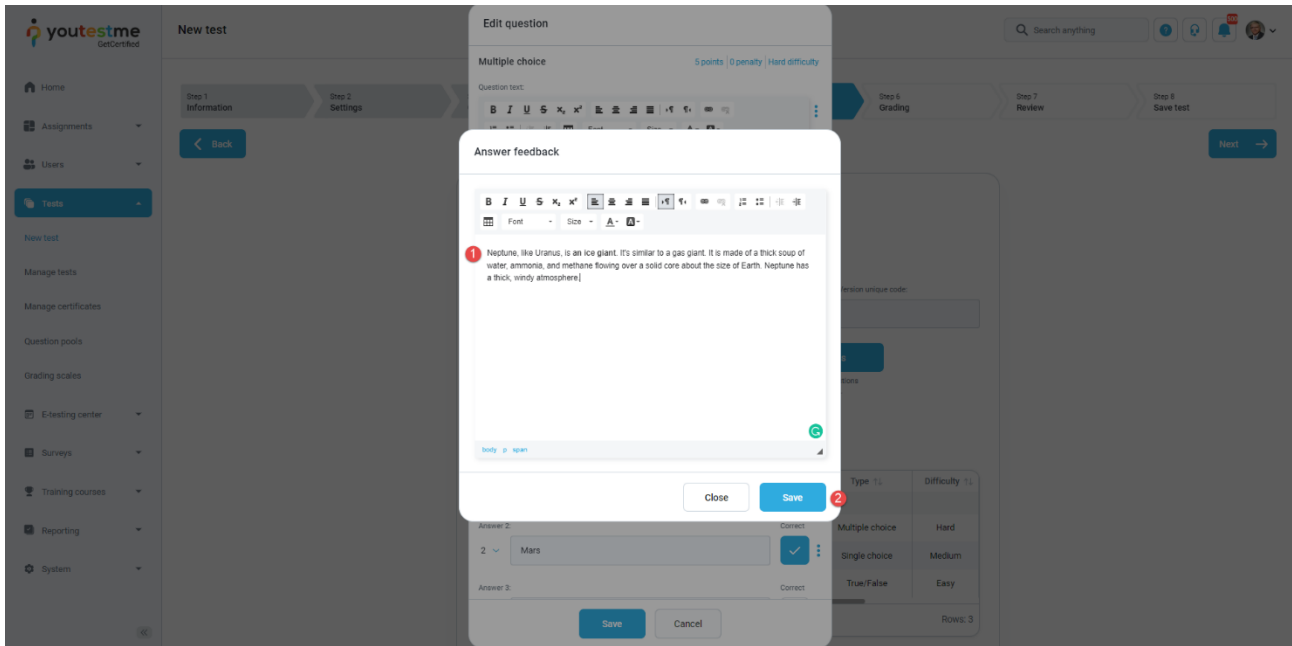

**Note:** You can define feedback for each or selected answers to a particular question.

Finish creating the question by clicking the **Add to test** button. You can edit or delete feedback by clicking the **Delete answer feedback**.

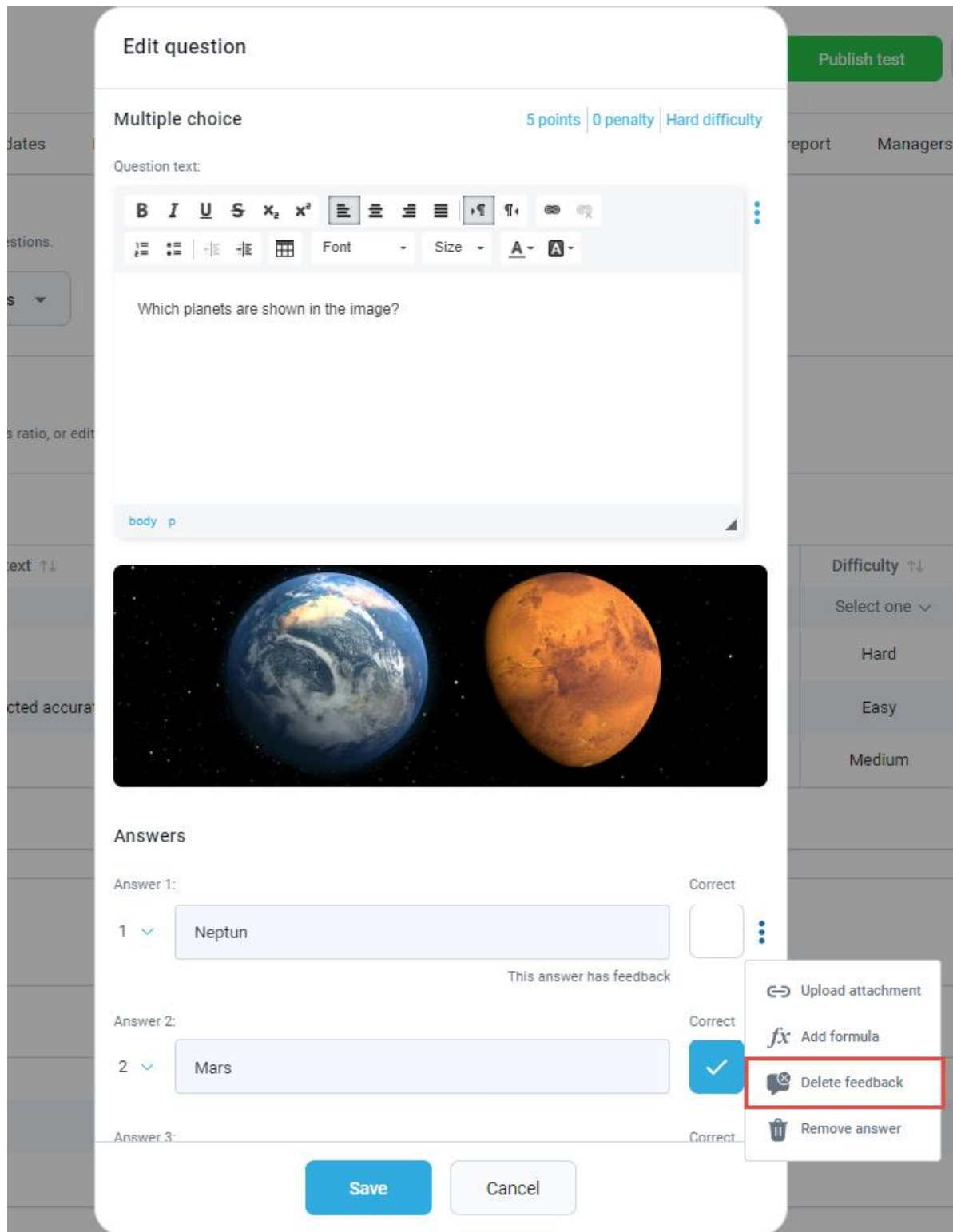

The screenshot shows the 'Edit question' modal in Youtestme. The question is a multiple-choice question with 5 points, 0 penalty, and Hard difficulty. The question text is 'Which planets are shown in the image?' and includes an image of Earth and Mars. There are two answers: 'Neptun' (marked incorrect) and 'Mars' (marked correct). A context menu is open over the 'Mars' answer, showing options: 'Upload attachment', 'Add formula', 'Delete feedback' (highlighted with a red box), and 'Remove answer'. The 'Delete feedback' option is the focus of the document.

You can add as many questions as you want, choose additional test settings, complete the Test Wizard and

publish the test.

**Note:** It is possible to add answer feedback for single-choice, multiple-choice, and true/false questions.

### 3 Displaying feedbacks from the candidate's perspective

In questions that contain answer feedback, when the candidate selects the desired answer(s) and clicks the **Next** or **Finish test** buttons, the feedback will appear.

An example is shown in the picture below.

