



YouTestMe

Allow users to get only specific test sections based on their data information

File name	Allow users to get only specific test sections based on their data information
Author	YouTestMe
Confidentiality	Internal or Public
Last save date	Friday, December-16-2022 at 4:08:00 PM

Table of Contents

1	Introduction.....	2
2	Creating a test with sections	3
2.1	Creating a testing session	4
2.2	Setting authorization	5
2.3	Defining conditions for sections.....	6
3	Executing the job	7
4	Student’s perspective.....	8
5	Assigning sections and their versions manually	9
6	Student’s perspective.....	10

1 Introduction

This document explains how to allow users to get only specific test sections based on their data information.

2 Creating a test with sections

Firstly, create a test with sections. To do so:

1. Select the **Tests** tab in the left side menu.
2. Select the **New test** tab.

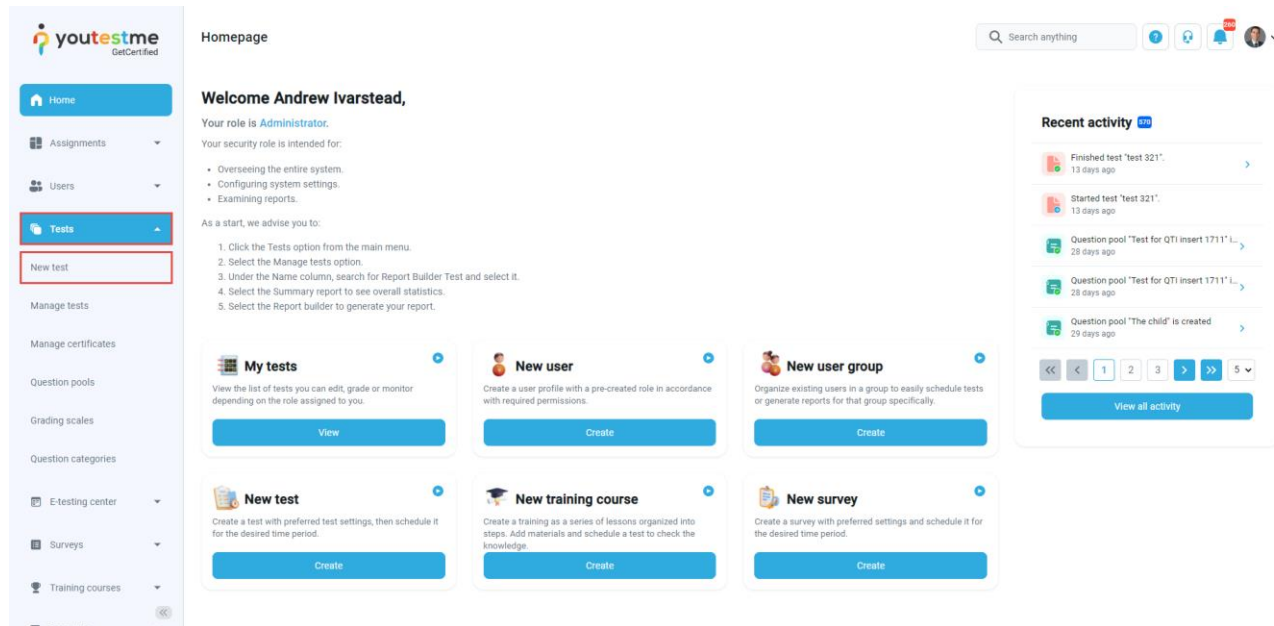

To create a test with sections, please check out this [article](#).

Note: You can create as much test versions as needed and manually assign the desired ones to the specific candidate.

2.1 Creating a testing session

To create a testing session, do the following:

1. Navigate to the **Testing sessions** tab.
2. Select the **New testing session** button.
3. Fill in all the mandatory fields.
4. Enable candidates' self-enrollment option.
5. Enable authorization.
6. Select the **Save** button to save the changes.

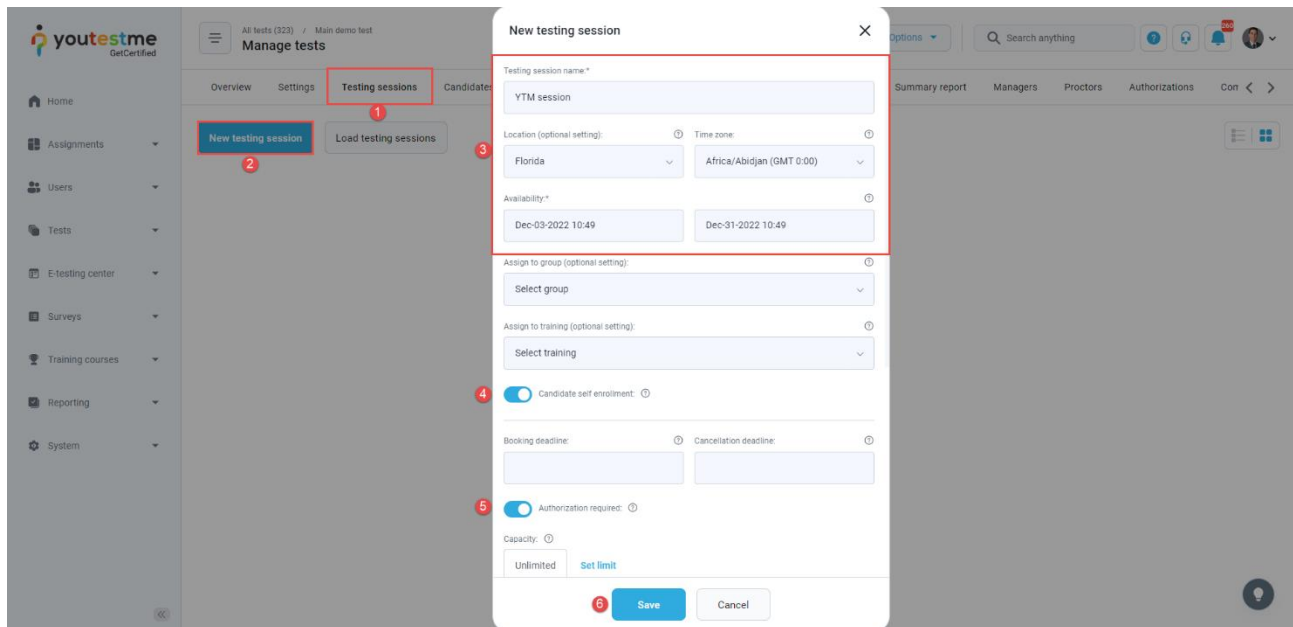

2.2 Setting authorization

After creating a test with sections, navigate to the test settings and tick the box with the **Enable section selection** option.

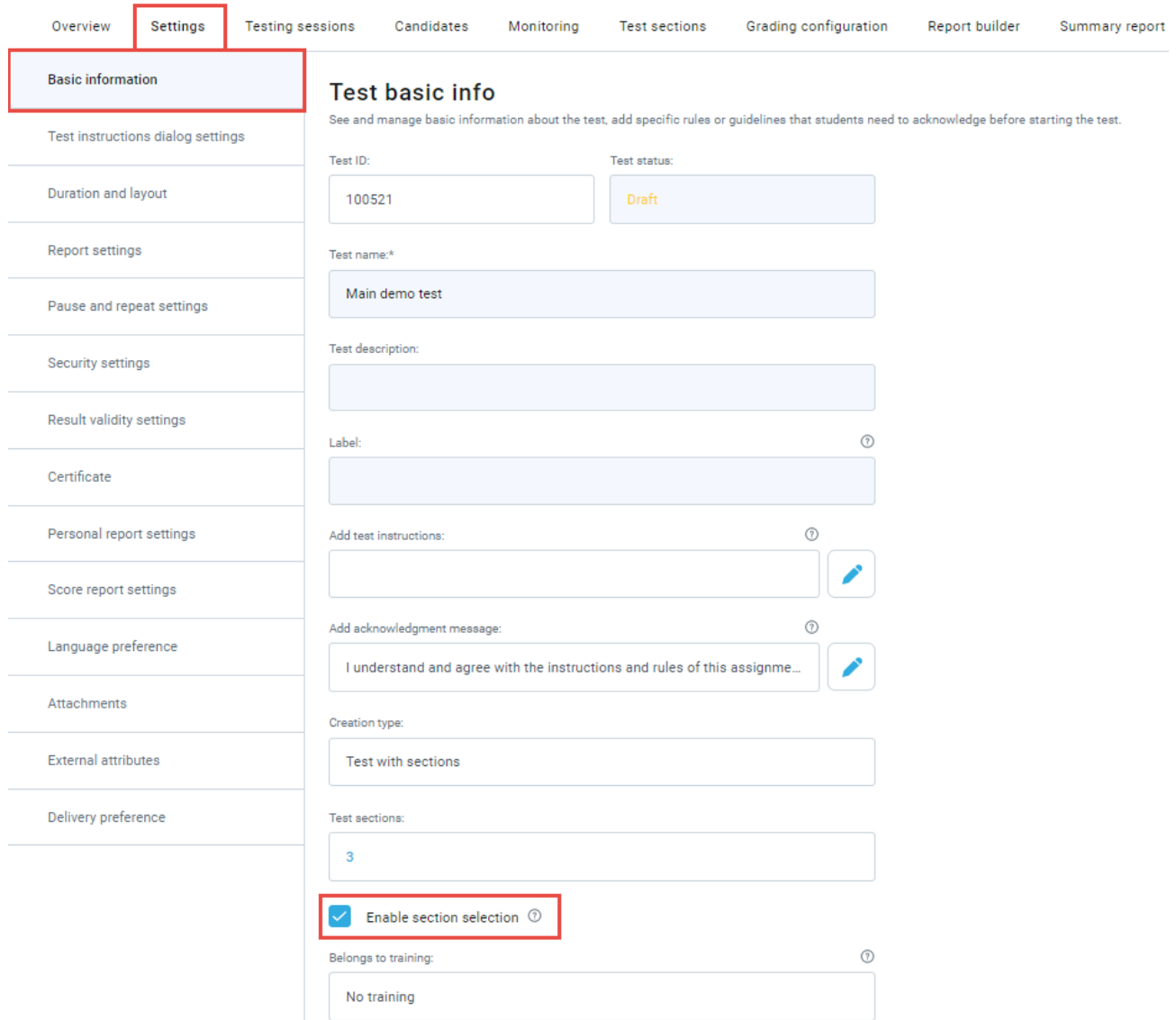

Overview **Settings** Testing sessions Candidates Monitoring Test sections Grading configuration Report builder Summary report

Basic information

- Test instructions dialog settings
- Duration and layout
- Report settings
- Pause and repeat settings
- Security settings
- Result validity settings
- Certificate
- Personal report settings
- Score report settings
- Language preference
- Attachments
- External attributes
- Delivery preference

Test basic info

See and manage basic information about the test, add specific rules or guidelines that students need to acknowledge before starting the test.

Test ID: 100521 Test status: Draft

Test name: Main demo test

Test description:

Label:

Add test instructions:

Add acknowledgment message: I understand and agree with the instructions and rules of this assignme...

Creation type: Test with sections

Test sections: 3

Enable section selection

Belongs to training: No training

2.3 Defining conditions for sections

Navigate to the **Sections** tab and select the **Details** option.

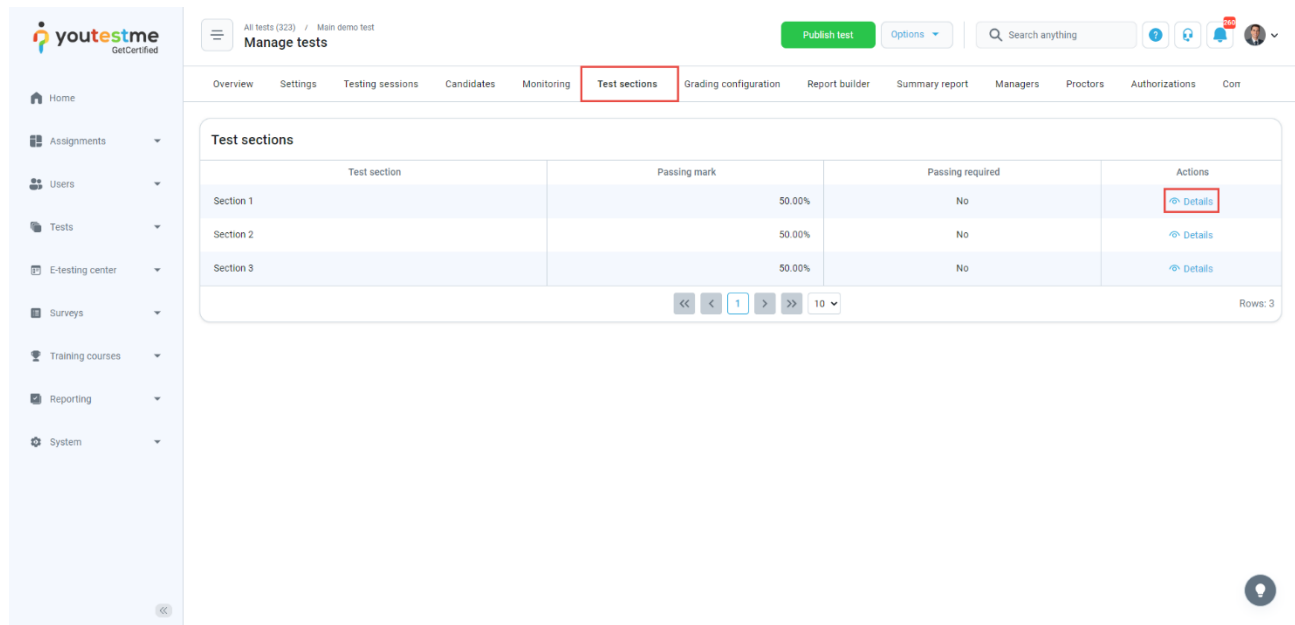

In the **Settings** tab, select the **Section auto-assignment** and define the desired conditions.

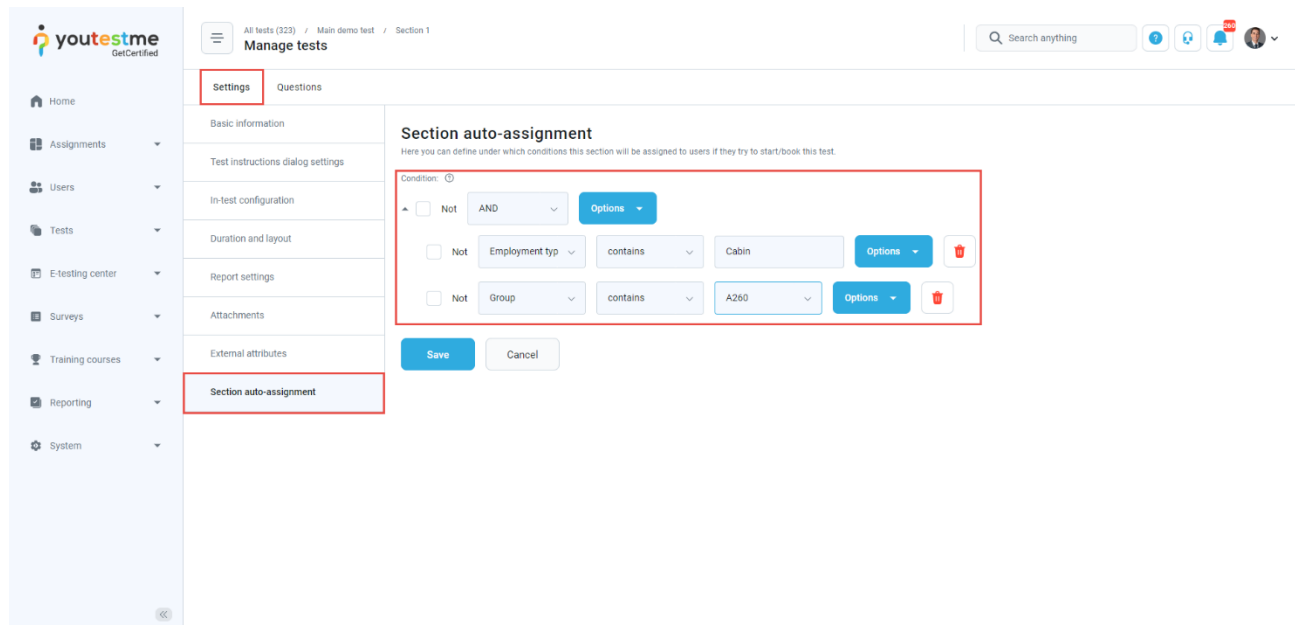

We have defined conditions to the first and third section. You can define conditions to any desired section.

In the **Authorizations** tab, tick the box with the **Enable conjunction of section conditions** option. The conditions of all sections will be conducted to this test authorization condition and cannot be manually changed

The screenshot shows the 'Manage tests' interface with the 'Authorizations' tab selected. A red box highlights the 'Enable conjunction of section conditions' checkbox. Below this, there are several conditions defined for authorization, each with a 'Not' checkbox, a logical operator (AND/OR), a field name, a comparison operator (contains), a value, and an 'Options' button. The conditions include:

- Employment typ contains Cabin
- Group contains A260
- Employment typ contains Cabin
- Group contains Fleets

3 Executing the job

After defining conditions to the desired sections, select the **System / System and customization** tab, and select the **Job scheduler** tab.

The screenshot shows the 'Settings and customization' interface. The 'System' tab is selected in the sidebar, and the 'Job scheduler' sub-tab is active. A table of jobs is displayed with the following columns: Name, Description, Last executed, Type, Status, Next run time, and ST. The table contains 8 rows of job data.

Name	Description	Last executed	Type	Status	Next run time	ST
Q Search	Q Search					
Import questions fr...		Aug-31-2021 02:01 ...	Import ques...	Finished		Aug-31
Import sample	Job scheduled in the past will not run.	Jan-28-2021 01:35 ...	Import data	Finished		Aug-31
Import questions fr...	Question pool ID: 101910	Sep-07-2021 01:31 ...	Import ques...	Finished		Sep-07
Import questions fr...	Question pool ID: 101910	Sep-07-2021 01:43 ...	Import ques...	Finished		Sep-07
Import questions fr...	Question pool ID: 101910	Sep-13-2021 03:31 ...	Import ques...	Finished		Sep-13
Import questions fr...	Question pool ID: 101910	Sep-13-2021 03:31 ...	Import ques...	Finished		Sep-13
Import Swiss users ...		Nov-07-2022 03:26 ...	Import Swis...	Finished		Nov-07
Assign authorizatio...		Dec-13-2022 01:27 ...	Assign auth...	Finished		Nov-07

Select the **Assign authorization job** or [create a new one](#) and execute it.

Select the **Execution history and logs** tab and select the preview button to preview the log of the executed job. You can find information that contains the number of users that satisfy the condition.

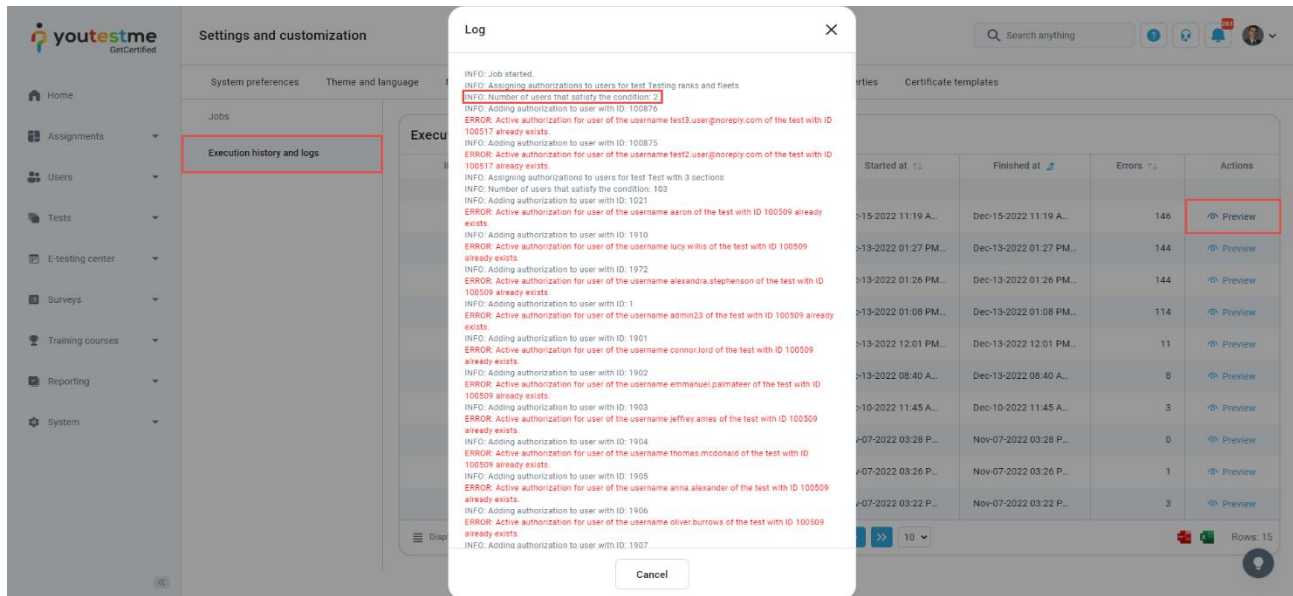

Going back to the **Authorizations** tab, you will be presented with the number of users that satisfy the conditions.

4 Student's perspective

Search for the desired test, book the desired session and click on the **Start** button to start the test.

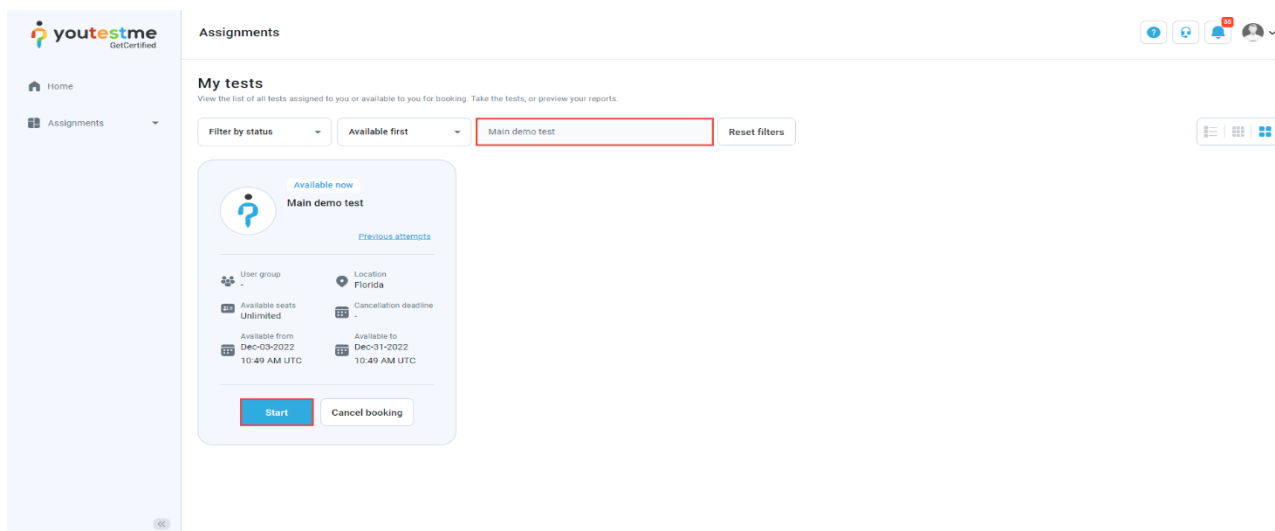

To students will be presented the sections which conditions they satisfy.

Main demo test > Section 1 Next question

Question: 1/3 Type: True/False

Uranus has 25 moons that we know of.

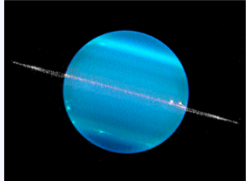

Decide whether the sentence above is true or false

1. True

2. False

Remaining time for entire test

00 59 05

Finish section Finish test

Section progress bar 0/3

Sections Questions

Section name	Started	Finished
1. Section 1	Dec-15-2022 1...	
2. Section 2		
3. Section 3		

5 Assigning sections and their versions manually

To assign sections and their versions manually, do the following:

1. In the **Candidates** tab select the **Reset** option.

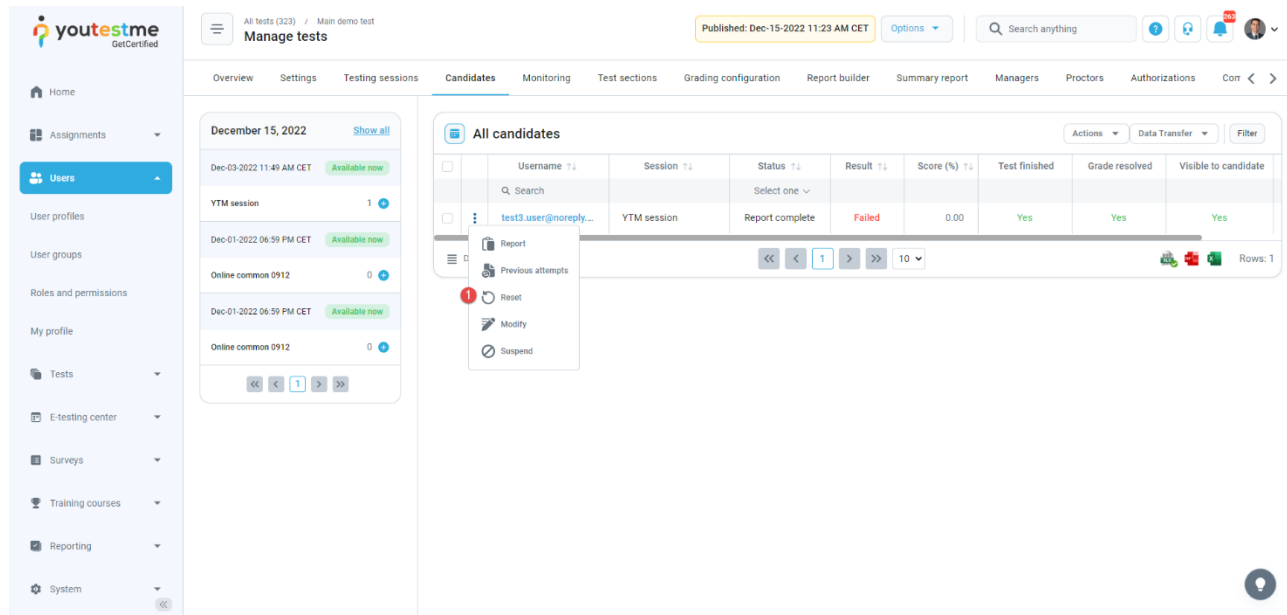

Published: Dec-15-2022 11:23 AM CET

Search anything

Overview Settings Testing sessions **Candidates** Monitoring Test sections Grading configuration Report builder Summary report Managers Proctors Authorizations Corr < >

December 15, 2022 [Show all](#)

Dec-03-2022 11:49 AM CET Available now

YTM session 1

Dec-01-2022 06:59 PM CET Available now

Online common 0912 0

Dec-01-2022 06:59 PM CET Available now

Online common 0912 0

All candidates

	Username	Session	Status	Result	Score (%)	Test finished	Grade resolved	Visible to candidate
	test3.user@noreply...	YTM session	Report complete	Failed	0.00	Yes	Yes	Yes

Report Previous attempts

Reset Modify Suspend

Rows: 1

2. Tick the checkbox next to the desired section(s) and choose the desired test version for the section.

For example, in the screenshot below, we chose the test version 1 and just the first section.

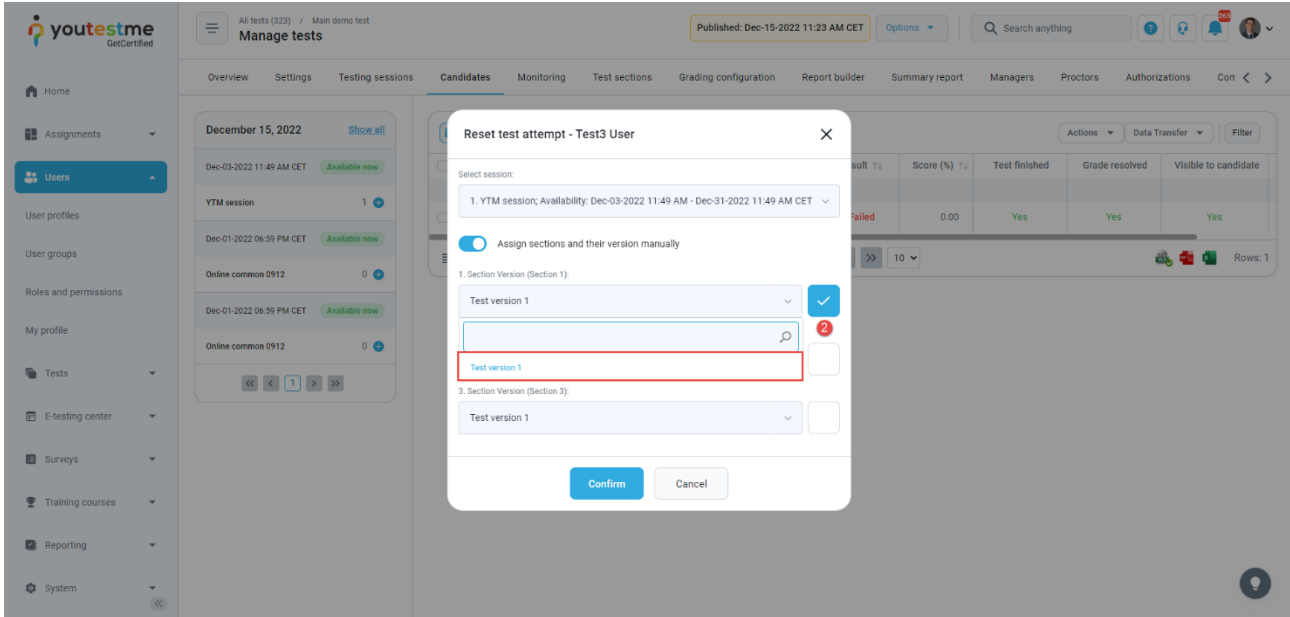

6 Student's perspective

To students will be presented the sections and their test versions that have been manually assigned to them.

